

ECT-SBK series

Immersible Pump



ECT PUMP

50HZ



PUMP

The ECT-SBK pumps are vertical multistage centrifugal pumps especially designed for pumping of cooling lubricants for machine tools, and to be mounted on top of tanks with the pump stack immersed in the pumped liquid.

ECT-SBK pumps are available with various pump sizes and various numbers of stages to provide the flow, the pressure and the length required.

APPLICSTIONS FEATURE

1. Cooling units
2. Grinding machines
3. Machine centers
4. Spark machine tools
5. Filtering systems
6. Milling machines
7. Boring machines
8. Drilling machines
9. Filtering systems
10. Swarf conveyors
11. Industrial washing machines

1. Compact design
2. High Efficiency Reliability
3. Easy installation
4. Flexible installation length
5. Wide performance range
6. Reliability
7. Service-friendly

PUMPED LIQUIDS

Do not pump the explosive or aggressive liquids and the liquids should be free of fibers.

The ECT-SBK pumps have the strainer in the suction chamber with inlet to prevent large particles from entering and damaging the pump.

In order to avoid the larger particles block the filters, we suggest to filtrate elementarily before pumping the liquids with particles.

MOTOR

1. ECT-SBK is fitted with totally enclosed fan-cooled, 2-pole standard motor.
2. Enclosure class : IP 55
3. Insulation class : F
4. Ambient temperature : Max. +50°C

Standard Voltages

	Phase	kW	Voltages
50Hz	3Ø	0.37- 2.2	220-240V / 380-415V
		3.0 - 22.0	220-240V / 380-415V
		3.0 - 22.0	380-415V / 660-720V
		30.0 - 45.0	400V / 690V

ECT-SBK



General Data

ECT PUMP

PERFORMANCE RANGE

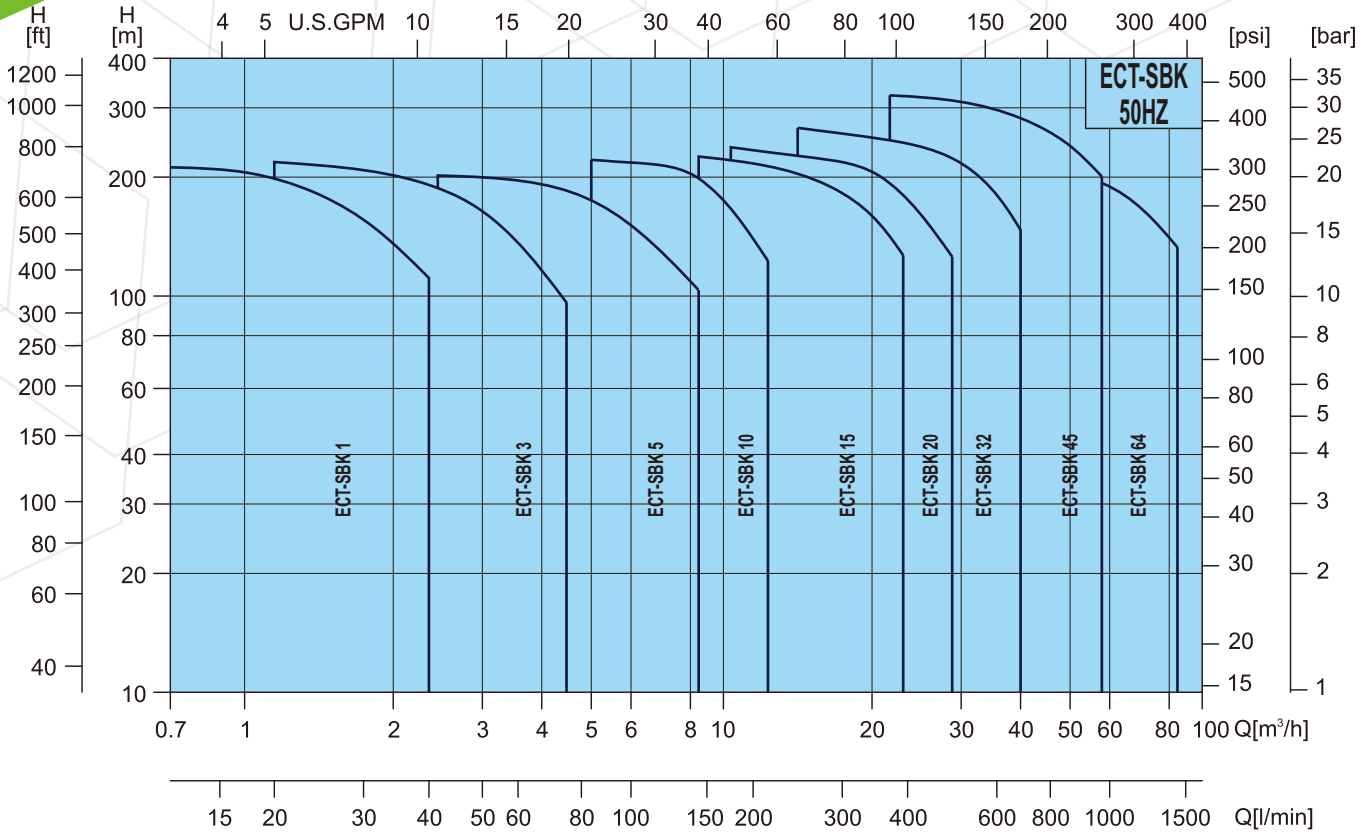

MODEL CODE

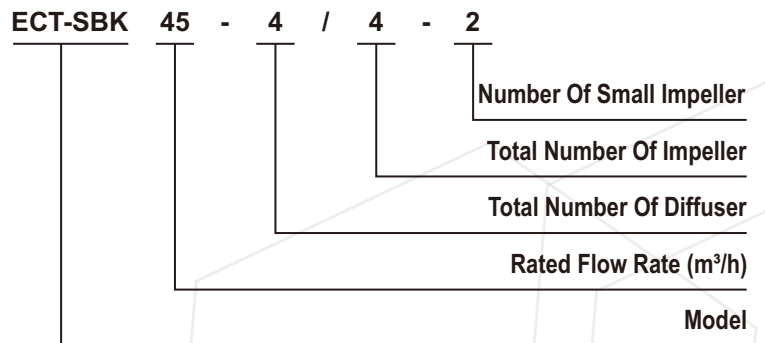
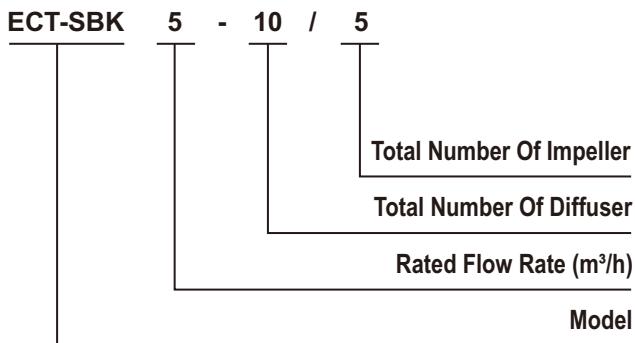

ECT-SBK



ECT PUMP

General Data

MECHANICAL SEALS

Standard Cartridge type mechanical seal made of Tungsten carbide/ Tungsten carbide Viton. The cartridge type mechanical seal can be replaced in minutes without special tools and without dismantling the pump.

Seal Type	ECT-SBK	
	1,3,5,10,15,20,32,45,64	
S: O-ring Seal Cartridge Type	●	
Seals Face Material		
QQ	○	
UU	●	
Rubber Material		
E	○	
V	●	

● Std. ○ Opt. - N/A

SUUV Standard

Mechanical seal is available in different material per customer's demand.

List of Materials	
Q : Silicon carbide	E : EPDM
U : Tungsten carbide	V : Viton



PRODUCT DATA

Range	1	3	5	10	15	20	32	45	64
Rated Flow Rate(m³/h)	1.0	3.0	5.0	10.0	17.0	21.0	32.0	45.0	64.0
Flow Range (m³/h)	0.7~2.4	1.2~4.5	2.5~8.5	5~13	8.5~23.5	10.5~29	15~40	22-58	30-85
Maximum Head (bar)	22	23	24	23	23	24	27	32	22
Motor Power (kW)	0.37~2.2	0.37~3.0	0.37~5.5	0.75~7.5	1.1~15.0	1.1~18.5	1.5~30.0	3.0~45.0	4.0~45.0
Temperature Range (°C)	-10 to +90								
Pipe Connection									
Union	Rp 1 1/4			Rp 2"					
Flange							DN65	DN80	

ECT-SBK

General Data



ECT PUMP

INSTALLATION

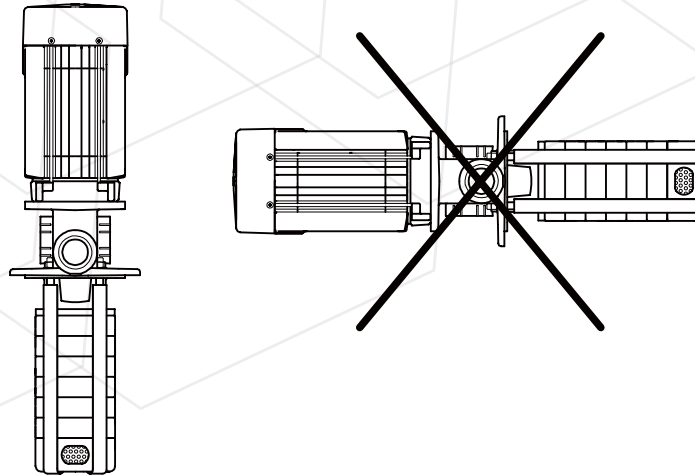

Note

- > When you install the ECT-SBK 1,3,5,10,15,20,32,45,64 series pumps, you must follow the instruction as below.
- > The distance between the liquid level and the pump bottom (Minimum) : A (mm)
- > The distance between the pump and the tank bottom (Minimum) : 25mm

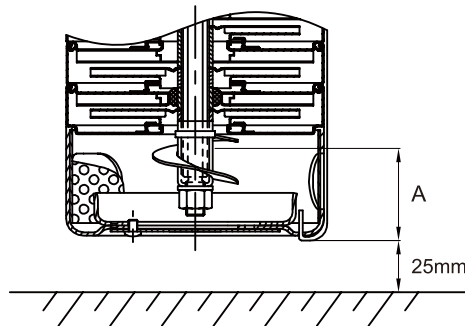
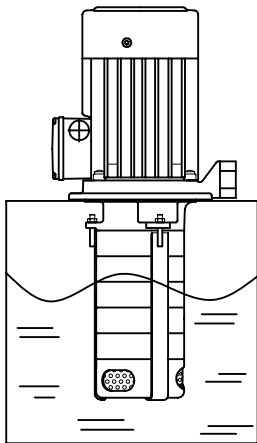

Model	A(mm)
ECT-SBK 1,3,5	40
ECT-SBK 10,15,20	50
ECT-SBK 32,45,64	70

Pump Type	Particles Handling Of Filter	Particles Handling Of Impeller
	mm	Max.mm
ECT-SBK 1	2.0	2.5
ECT-SBK 3	2.0	3.1
ECT-SBK 5	4.0	5.5
ECT-SBK 10	4.0	5.5
ECT-SBK 15	4.0	6.0
ECT-SBK 20	4.0	7.9
ECT-SBK 32	4.0	8.0
ECT-SBK 45	4.0	9.5
ECT-SBK 64	4.0	13.0

NOTE: Do not remove the filters.

MATERIALS

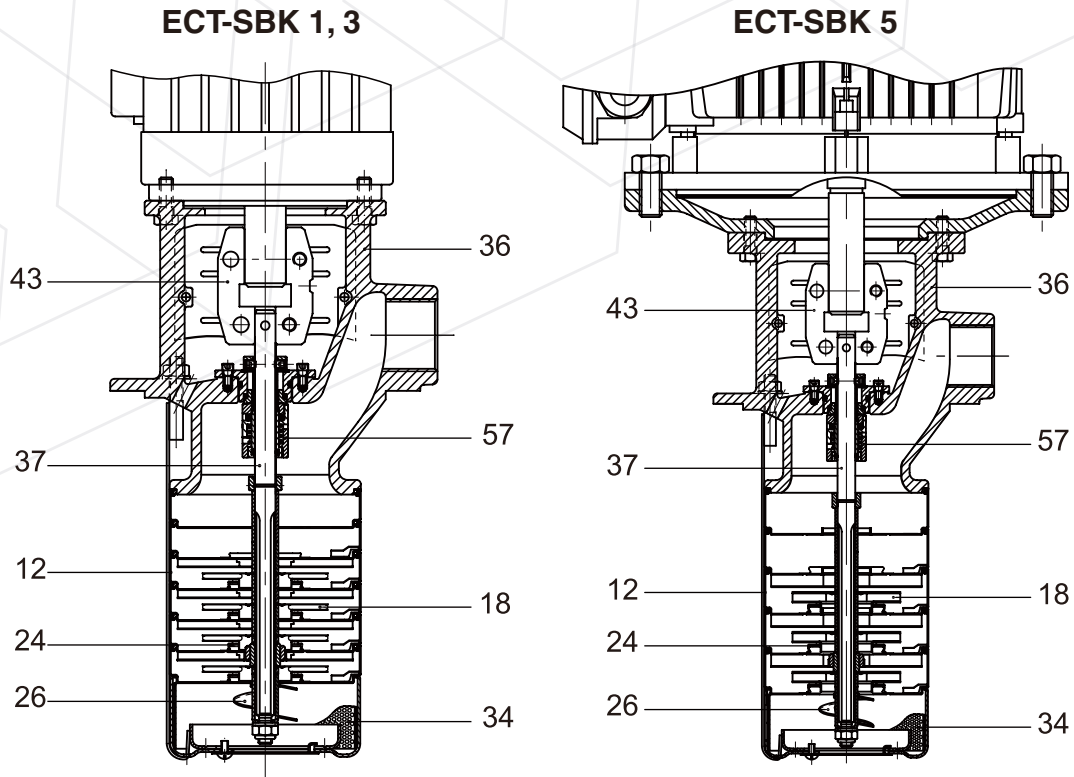

Pos.	Name	Material	Europe	AISI/ASTM
12	Chamber complete	Stainless steel	1.4301	AISI 304
18	Impeller	Stainless steel	1.4301	AISI 304
24	Neck ring	PTFE		
26	Priming screw	Stainless steel	1.4301	AISI 304
34	Strainer	Stainless steel	1.4301	AISI 304
36	Pump head	Cast Iron EN-GJL-200	0.6020	ASTM 25B
37	Pump shaft	Stainless steel	1.4057	AISI 431
43	Coupling			
57	Shaft seal	SUUV		

ECT-SBK

General Data

MATERIALS



ECT PUMP

ECT-SBK 10, 15, 20

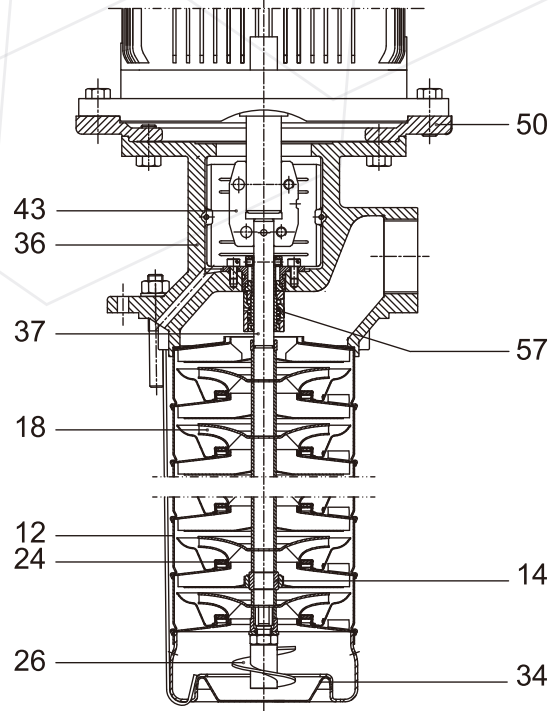

Pos.	Name	Material	Europe	AISI/ASTM
12	Chamber complete	Stainless steel	1.4301	AISI 304
14	Bearing ring	Sic		
18	Impeller	Stainless steel	1.4301	AISI 304
24	Neck ring	PTFE		
26	Priming screw	Stainless steel	1.4301	AISI 304
34	Strainer	Stainless steel	1.4301	AISI 304
36	Pump head	Cast Iron EN-GJL-200	0.6020	ASTM 25B
37	Pump shaft	Stainless steel	1.4057	AISI 431
43	Coupling			
50	Motor stool	EN-GJL-200	0.6020	ASTM 25B
57	Shaft seal	SUUV		

MATERIALS

ECT-SBK 32, 45, 64

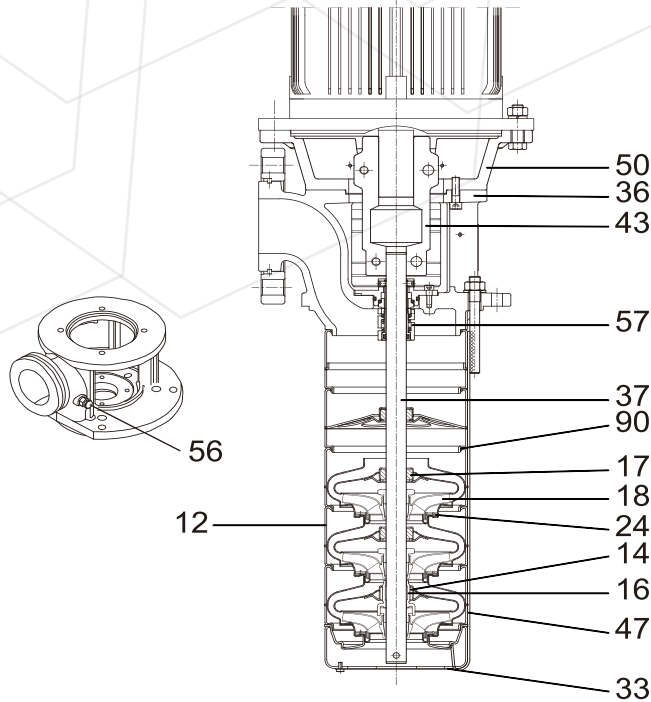

Pos.	Name	Material	Europe	AISI/ASTM
12	Chamber complete	Stainless steel	1.4301	AISI 304
14	Bearing ring, sta	Tungsten carbide		
16	Bearing ring, rot	Tungsten carbide		
17	Bush	POB complete		
18	Impeller	Stainless steel	1.4301	AISI 304
24	Neck ring	PTFE		
33	Suction strainer, Ø4mm holes	Stainless steel	1.4301	AISI 304
36	Pump head	Cast Iron	EN-GJL-200	ASTM 25B
37	Pump shaft	Stainless steel	1.4057	AISI 431
43	Coupling	Cast Iron	EN-GJL-500-7	ASTM 80-55-06
47	Strap	Stainless steel	1.4301	AISI 304
50	Motor stool	Cast Iron	EN-GJL-250	ASTM 35B
56	Air vent screw	Stainless steel	1.4301	AISI 304
57	Shaft seal	SUUV		
90	*O-ring	NBR		

*Only used in pumps with empty chambers

ECT-SBK

Technical Data



ECT PUMP

Performance Range

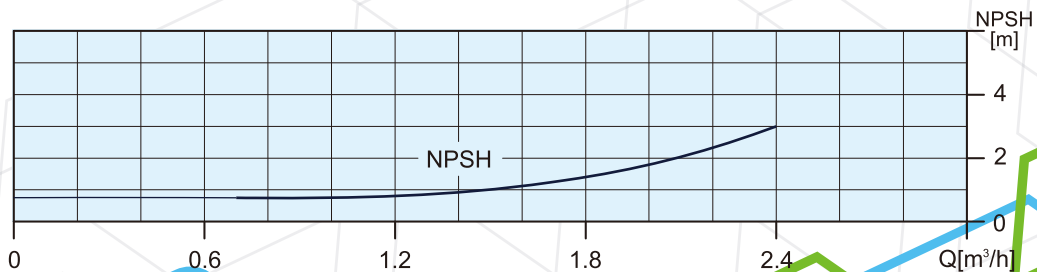
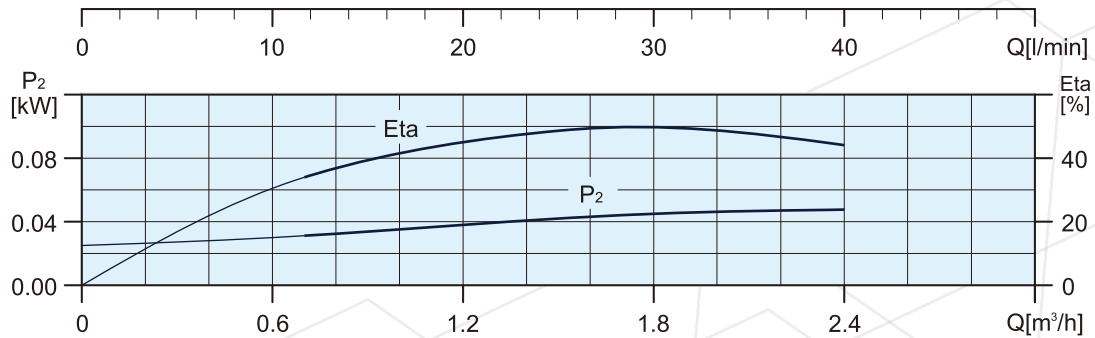
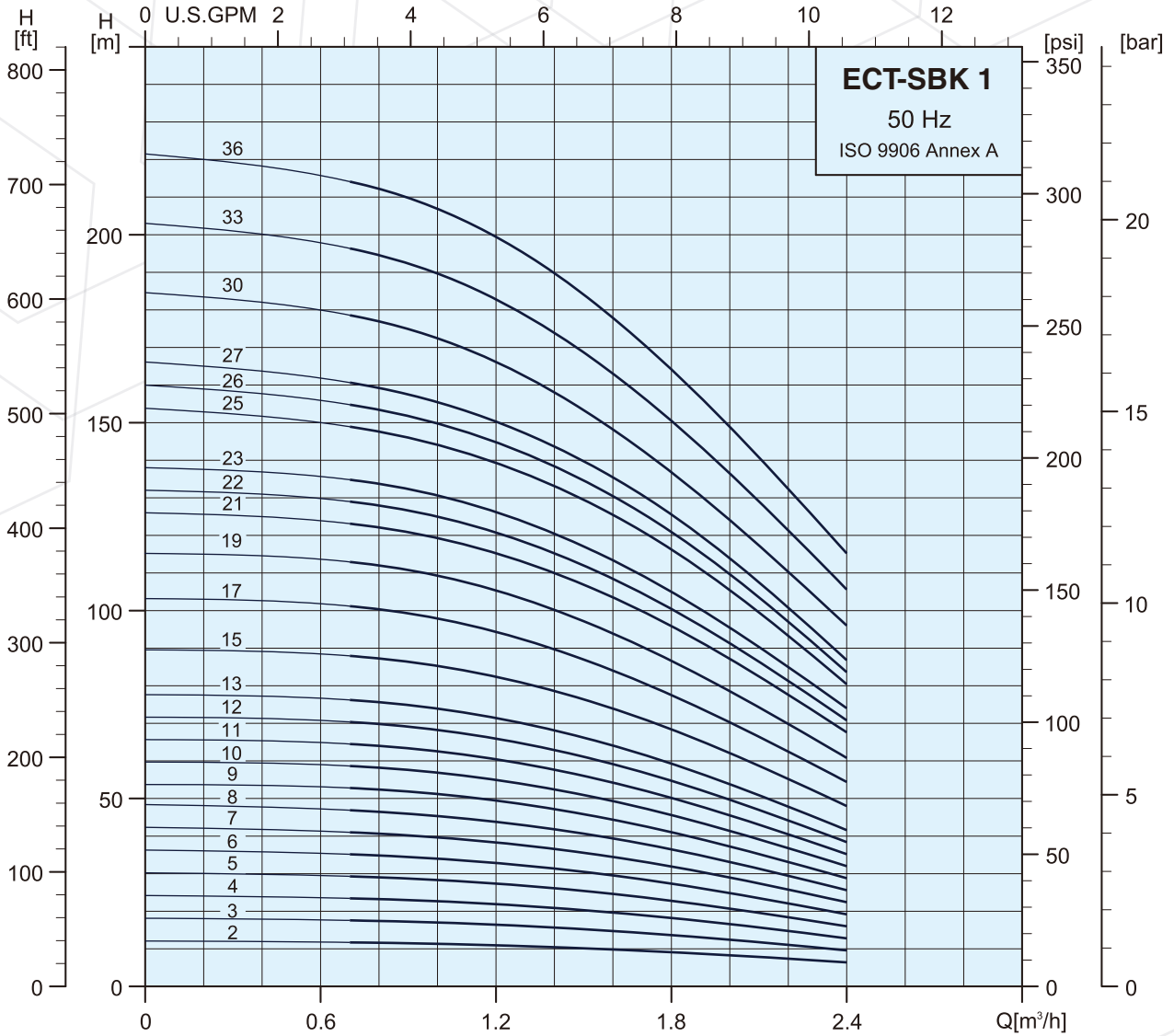

Specifications

Pump Type	Motor	
	P ₂	
	kW	HP
ECT-SBK 1-2/2	0.37	0.5
ECT-SBK 1-3/3	0.37	0.5
ECT-SBK 1-4/4	0.37	0.5
ECT-SBK 1-5/5	0.37	0.5
ECT-SBK 1-6/6	0.37	0.5
ECT-SBK 1-7/7	0.37	0.5
ECT-SBK 1-8/8	0.55	0.75
ECT-SBK 1-9/9	0.55	0.75
ECT-SBK 1-10/10	0.55	0.75
ECT-SBK 1-11/11	0.55	0.75
ECT-SBK 1-12/12	0.75	1.0
ECT-SBK 1-13/13	0.75	1.0
ECT-SBK 1-15/15	0.75	1.0
ECT-SBK 1-17/17	1.1	1.5
ECT-SBK 1-19/19	1.1	1.5
ECT-SBK 1-21/21	1.1	1.5
ECT-SBK 1-22/22	1.1	1.5
ECT-SBK 1-23/23	1.1	1.5
ECT-SBK 1-25/25	1.5	2.0
ECT-SBK 1-26/26	1.5	2.0
ECT-SBK 1-27/27	1.5	2.0
ECT-SBK 1-30/30	1.5	2.0
ECT-SBK 1-33/33	2.2	3.0
ECT-SBK 1-36/36	2.2	3.0

Dimensions and Weights

Dimensions (mm)							Net Weight (kg)
H1	H2	H3	D1	D2	D3		
465.4	160	305.4	141	115	140	12.1	
483.4	178	305.4	141	115	140	12.3	
501.4	196	305.4	141	115	140	12.5	
519.4	214	305.4	141	115	140	12.7	
537.4	232	305.4	141	115	140	13.0	
555.4	250	305.4	141	115	140	13.2	
573.4	268	305.4	141	115	140	13.9	
591.4	286	305.4	141	115	140	14.2	
609.4	304	305.4	141	115	140	14.4	
627.4	322	305.4	141	115	140	14.6	
685.4	340	345.4	141	115	140	16.5	
703.4	358	345.4	141	115	140	16.7	
739.4	394	345.4	141	115	140	17.1	
829.4	430	399.4	177	141	140	24.3	
865.4	466	399.4	177	141	140	24.8	
901.4	502	399.4	177	141	140	25.2	
919.4	520	399.4	177	141	140	25.5	
937.4	538	399.4	177	141	140	25.7	
979.4	574	405.4	177	141	140	29.8	
997.4	592	405.4	177	141	140	30.0	
1015.4	610	405.4	177	141	140	30.2	
1069.4	664	405.4	177	141	140	30.9	
1123.4	718	405.4	177	141	140	33.8	
1177.4	772	405.4	177	141	140	34.5	

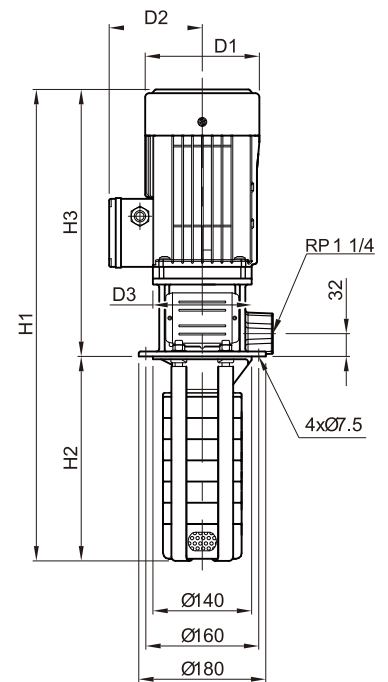
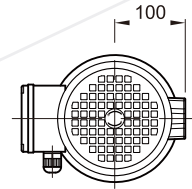

Performance Range

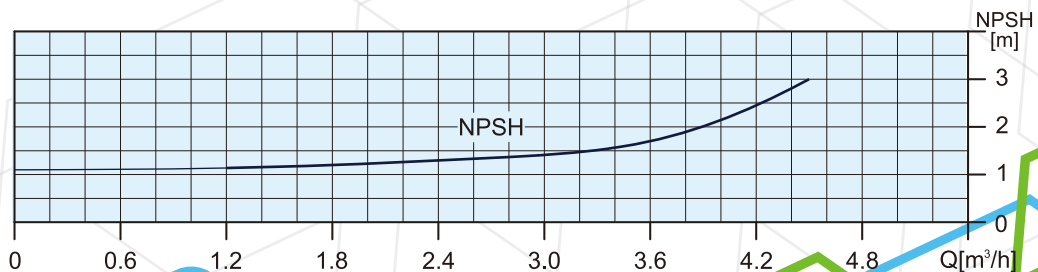
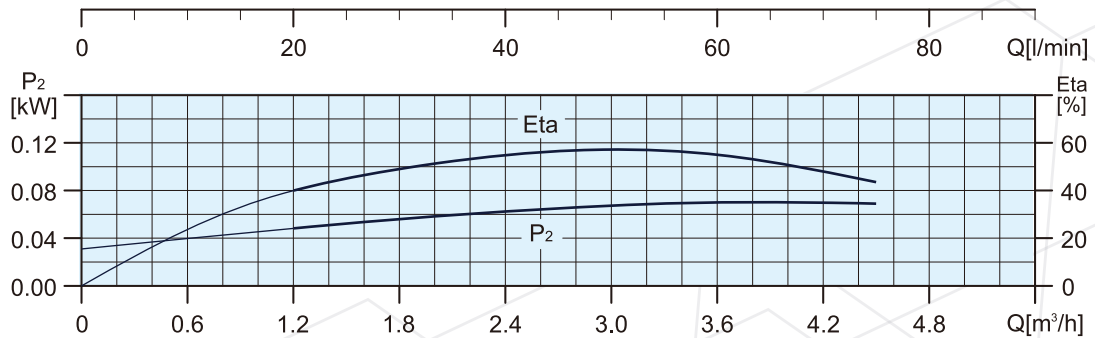
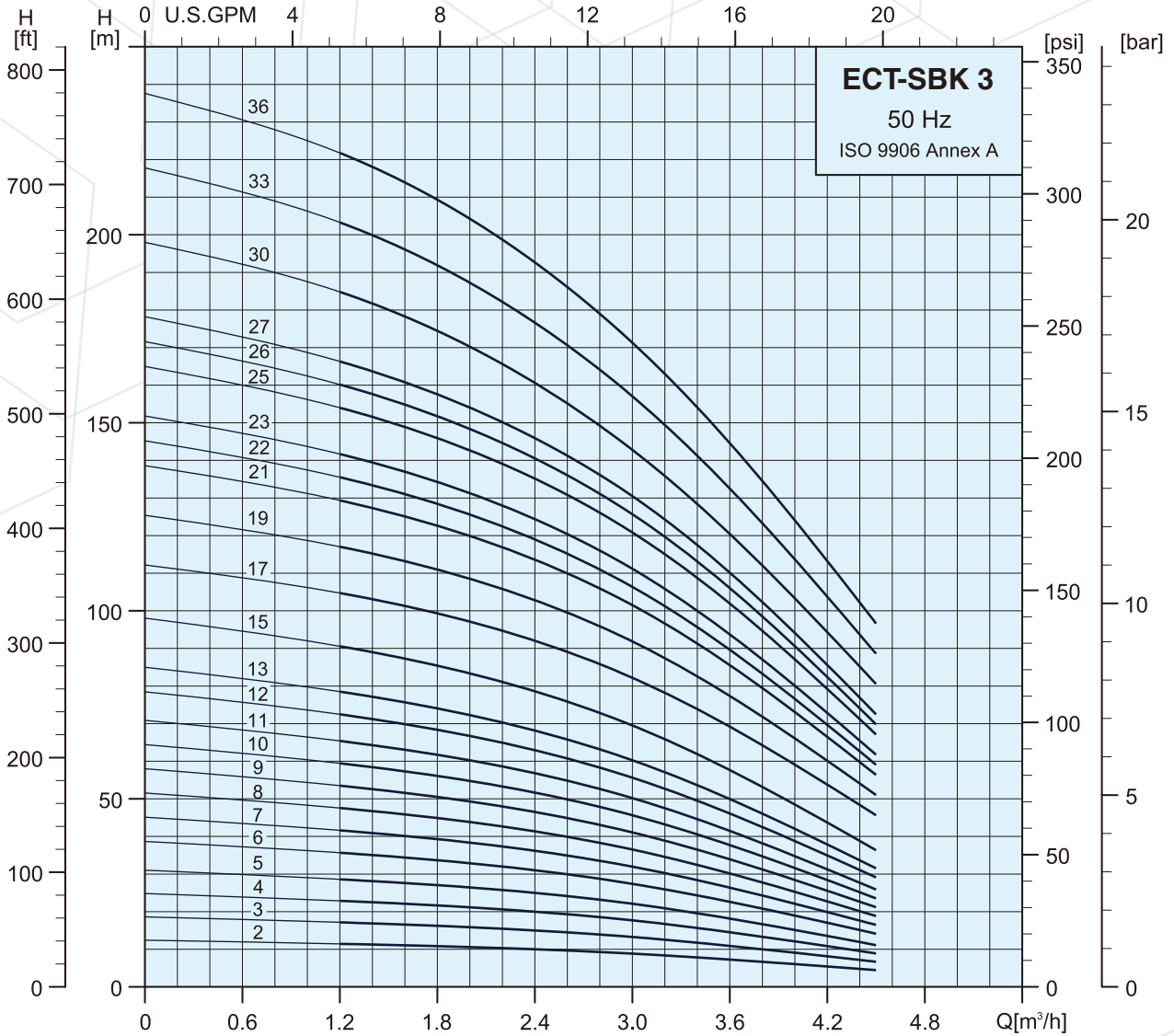

Specifications

Pump Type	Motor	
	P ₂	
	kW	HP
ECT-SBK 3-2/2	0.37	0.5
ECT-SBK 3-3/3	0.37	0.5
ECT-SBK 3-4/4	0.37	0.5
ECT-SBK 3-5/5	0.37	0.5
ECT-SBK 3-6/6	0.55	0.75
ECT-SBK 3-7/7	0.55	0.75
ECT-SBK 3-8/8	0.75	1.0
ECT-SBK 3-9/9	0.75	1.0
ECT-SBK 3-10/10	0.75	1.0
ECT-SBK 3-11/11	0.75	1.0
ECT-SBK 3-12/12	1.1	1.5
ECT-SBK 3-13/13	1.1	1.5
ECT-SBK 3-15/15	1.1	1.5
ECT-SBK 3-17/17	1.5	2.0
ECT-SBK 3-19/19	1.5	2.0
ECT-SBK 3-21/21	2.2	3.0
ECT-SBK 3-22/22	2.2	3.0
ECT-SBK 3-23/23	2.2	3.0
ECT-SBK 3-25/25	2.2	3.0
ECT-SBK 3-26/26	2.2	3.0
ECT-SBK 3-27/27	2.2	3.0
ECT-SBK 3-30/30	3.0	4.0
ECT-SBK 3-33/33	3.0	4.0
ECT-SBK 3-36/36	3.0	4.0

Dimensions and Weights

Dimensions (mm)						Net Weight (kg)
H1	H2	H3	D1	D2	D3	
465.4	160	305.4	141	115	140	12.1
483.4	178	305.4	141	115	140	12.3
501.4	196	305.4	141	115	140	12.5
519.4	214	305.4	141	115	140	12.7
537.4	232	305.4	141	115	140	13.5
555.4	250	305.4	141	115	140	13.7
613.4	268	345.4	141	115	140	15.5
631.4	286	345.4	141	115	140	15.8
649.4	304	345.4	141	115	140	16.0
667.4	322	345.4	141	115	140	16.2
739.4	340	399.4	177	141	140	23.2
757.4	358	399.4	177	141	140	23.4
793.4	394	399.4	177	141	140	23.9
835.4	430	405.4	177	141	140	27.9
871.4	466	405.4	177	141	140	28.4
907.4	502	405.4	177	141	140	31.1
925.4	520	405.4	177	141	140	31.3
943.4	538	405.4	177	141	140	31.5
979.4	574	405.4	177	141	140	32.0
997.4	592	405.4	177	141	140	32.2
1015.4	610	405.4	177	141	140	32.4
1095.9	664	431.9	197	147	160	35.4
1149.9	718	431.9	197	147	160	37.0
1203.9	772	431.9	197	147	160	37.7

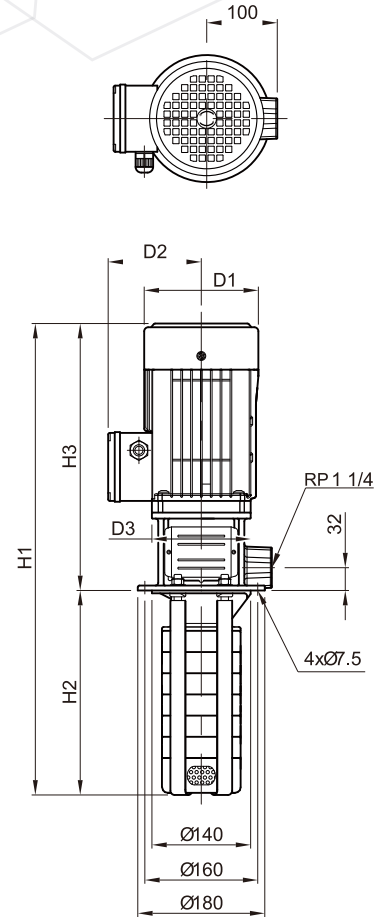

ECT-SBK

Technical Data



ECT PUMP

Performance Range

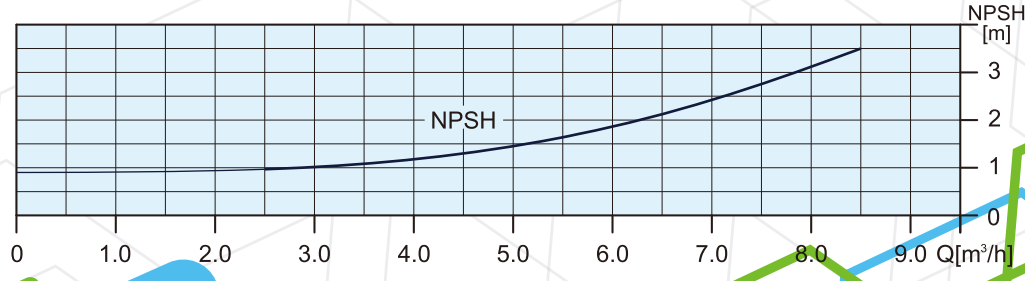
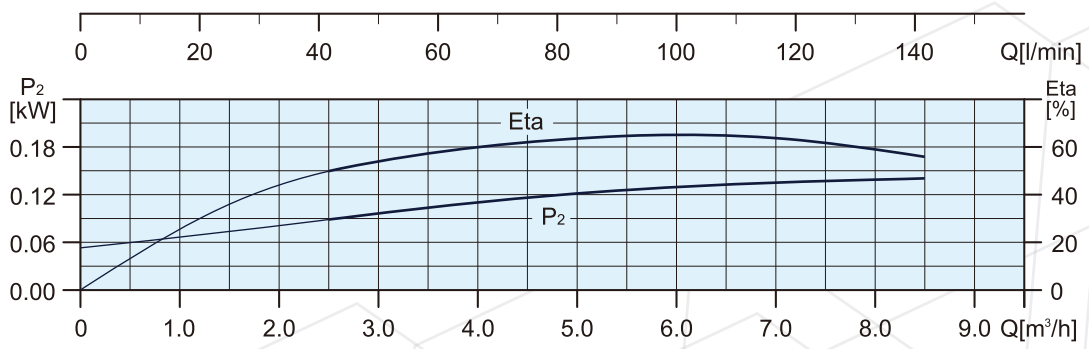
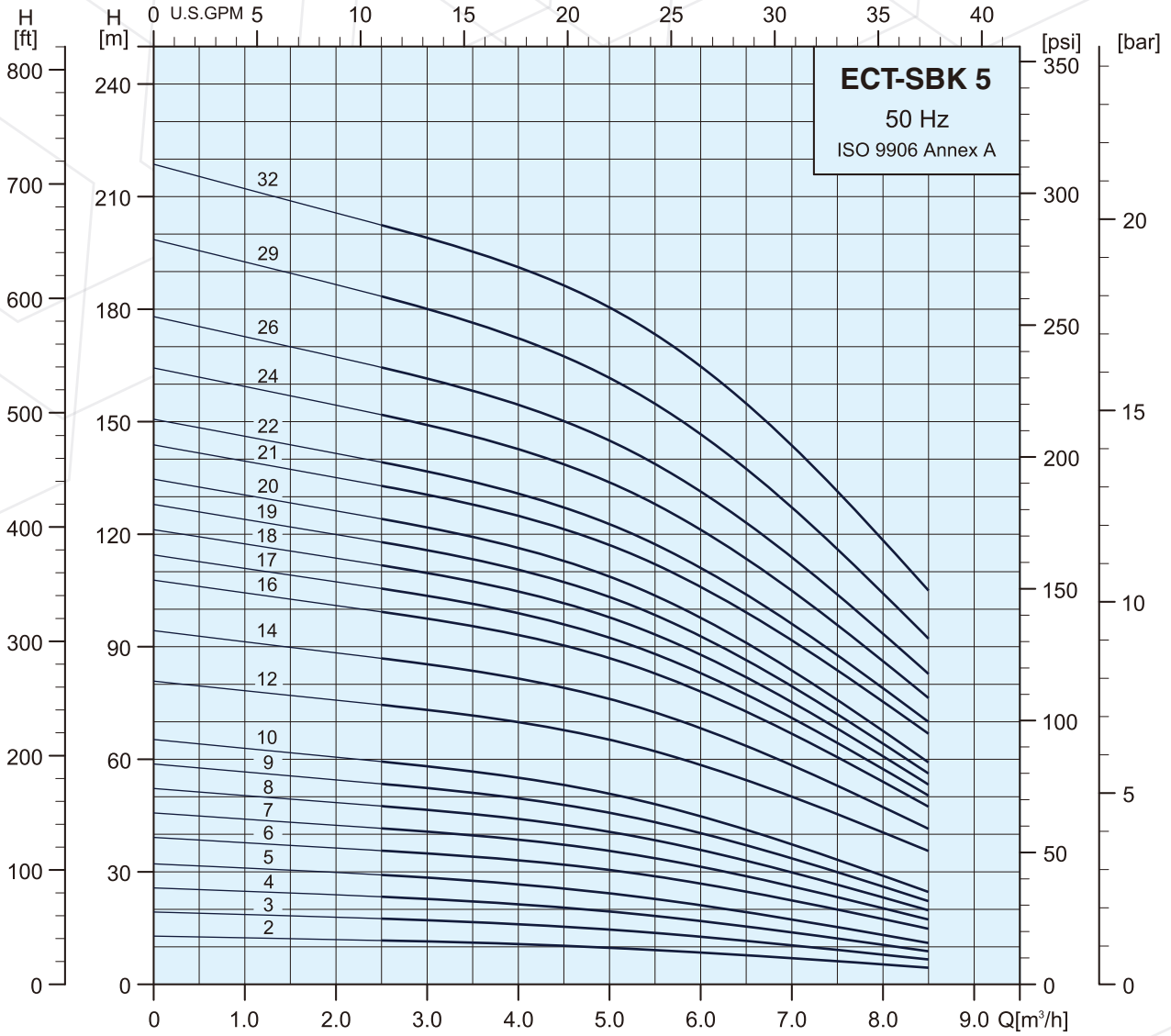

Specifications

Pump Type	Motor	
	P ₂	
	kW	HP
ECT-SBK 5-2/2	0.37	0.5
ECT-SBK 5-3/3	0.55	0.75
ECT-SBK 5-4/4	0.55	0.75
ECT-SBK 5-5/5	0.75	1.0
ECT-SBK 5-6/6	1.1	1.5
ECT-SBK 5-7/7	1.1	1.5
ECT-SBK 5-8/8	1.1	1.5
ECT-SBK 5-9/9	1.5	2.0
ECT-SBK 5-10/10	1.5	2.0
ECT-SBK 5-12/12	2.2	3.0
ECT-SBK 5-14/14	2.2	3.0
ECT-SBK 5-16/16	2.2	3.0
ECT-SBK 5-17/17	3.0	4.0
ECT-SBK 5-18/18	3.0	4.0
ECT-SBK 5-19/19	3.0	4.0
ECT-SBK 5-20/20	3.0	4.0
ECT-SBK 5-21/21	3.0	4.0
ECT-SBK 5-22/22	4.0	5.5
ECT-SBK 5-24/24	4.0	5.5
ECT-SBK 5-26/26	4.0	5.5
ECT-SBK 5-29/29	4.0	5.5
ECT-SBK 5-32/32	5.5	7.5

Dimensions and Weights

Dimensions (mm)						Net Weight (kg)
H1	H2	H3	D1	D2	D3	
492.4	187	305.4	141	115	140	12.2
519.4	214	305.4	141	115	140	13.1
546.4	241	305.4	141	115	140	13.4
613.4	268	345.4	141	115	140	15.4
694.4	295	399.4	177	141	140	22.5
721.4	322	399.4	177	141	140	22.9
748.4	349	399.4	177	141	140	23.2
781.4	376	405.4	177	141	140	27.8
808.4	403	405.4	177	141	140	28.1
862.4	457	405.4	177	141	140	30.7
916.4	511	405.4	177	141	140	31.1
970.4	565	405.4	177	141	140	31.4
1023.9	592	431.9	197	147	160	35.9
1050.9	619	431.9	197	147	160	36.3
1077.9	646	431.9	197	147	160	36.6
1104.9	673	431.9	197	147	160	37.0
1131.9	700	431.9	197	147	160	37.4
1168.9	727	441.9	220	161	160	47.6
1222.9	781	441.9	220	161	160	48.4
1276.9	835	441.9	220	161	160	49.1
1357.9	916	441.9	220	161	160	50.2
1503.9	997	506.9	235	197	300	70.3

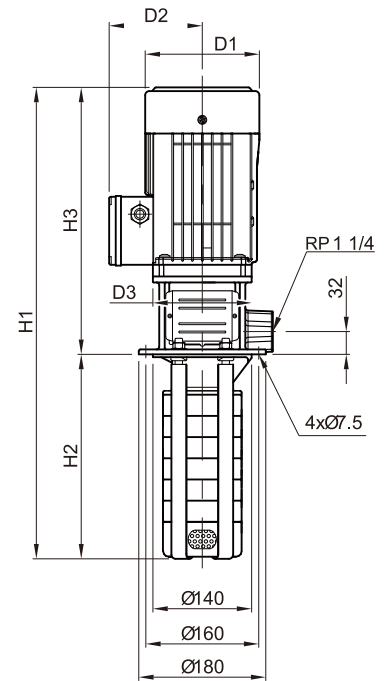
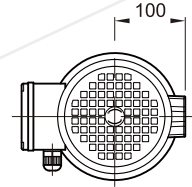

Performance Range

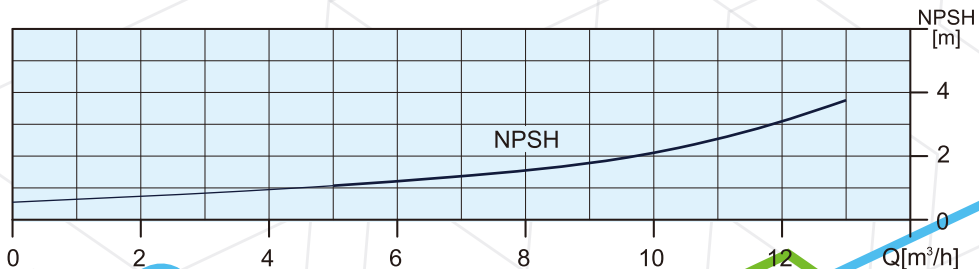
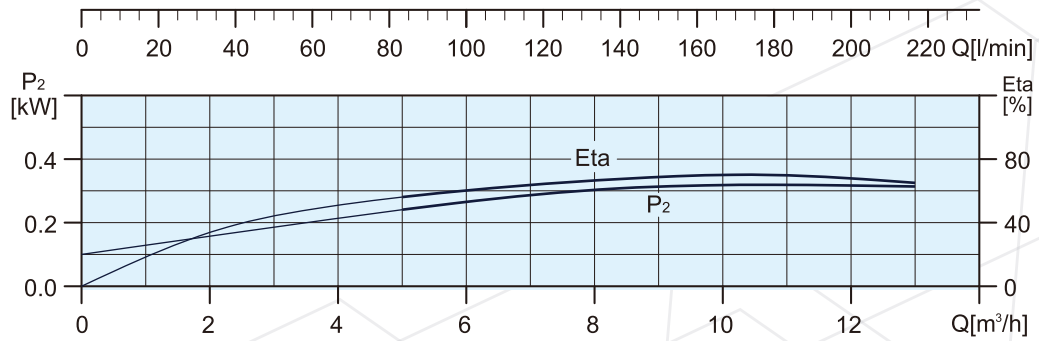
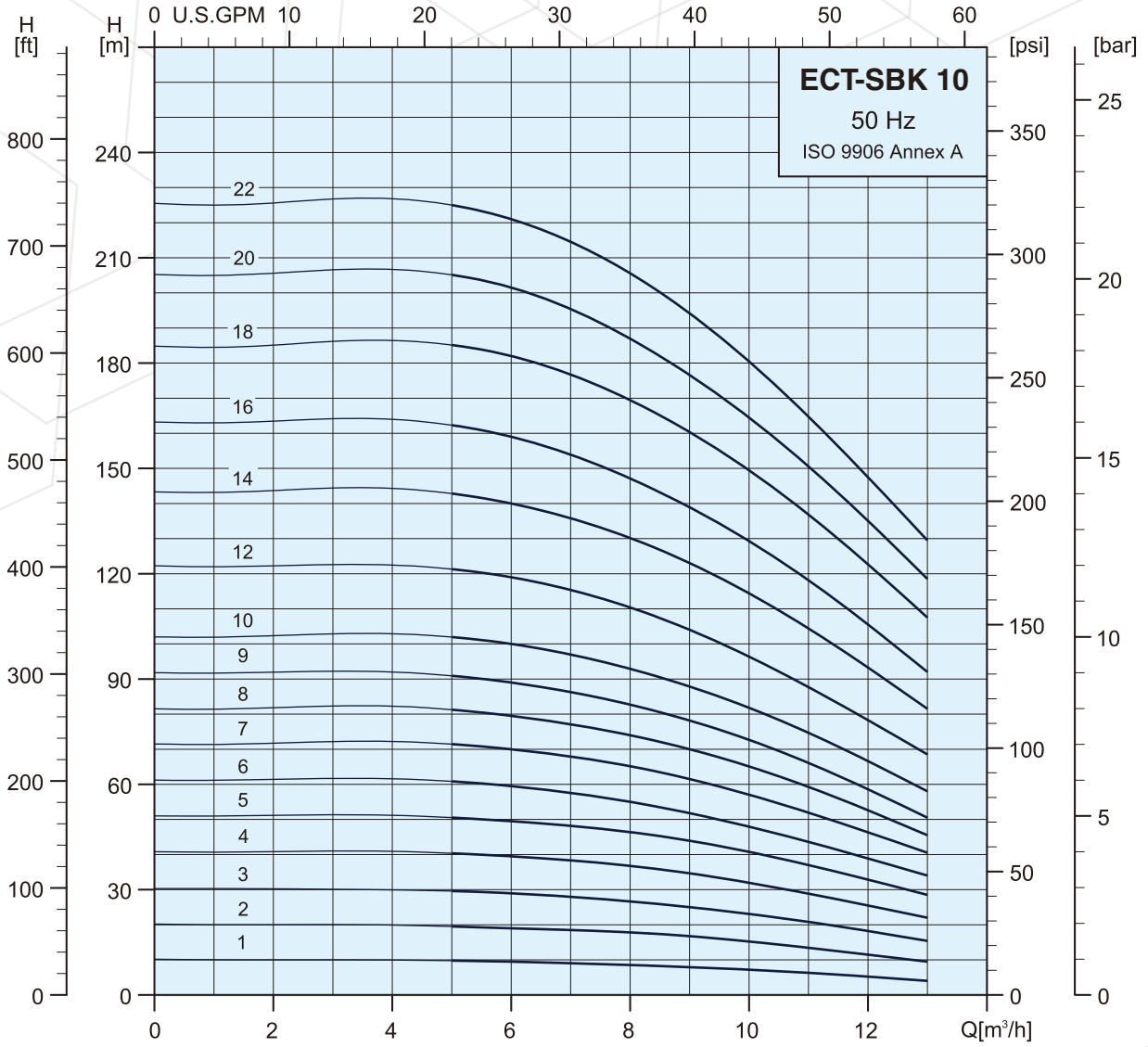

Specifications

Pump Type	Motor	
	P ₂	
	kW	HP
ECT-SBK 10-2/1	0.75	1.0
ECT-SBK 10-2/2	0.75	1.0
ECT-SBK 10-3/3	1.1	1.5
ECT-SBK 10-4/4	1.5	2.0
ECT-SBK 10-5/5	2.2	3.0
ECT-SBK 10-6/6	2.2	3.0
ECT-SBK 10-7/7	3.0	4.0
ECT-SBK 10-8/8	3.0	4.0
ECT-SBK 10-9/9	3.0	4.0
ECT-SBK 10-10/10	4.0	5.5
ECT-SBK 10-12/12	4.0	5.5
ECT-SBK 10-14/14	5.5	7.5
ECT-SBK 10-16/16	5.5	7.5
ECT-SBK 10-18/18	7.5	10.0
ECT-SBK 10-20/20	7.5	10.0
ECT-SBK 10-22/22	7.5	10.0

Dimensions and Weights

Dimensions (mm)						Net Weight (kg)
H1	H2	H3	D1	D2	HD	
523	148	375	141	140	115	21.7
523	148	375	141	140	115	21.8
607	178	429	177	140	141	29.3
643	208	435	177	140	141	33.8
673	238	435	177	140	141	36.9
703	268	435	177	140	141	37.6
755	298	457	197	160	147	44.3
785	328	457	197	160	147	45.0
815	358	457	197	160	147	45.9
855	388	467	220	160	161	53.4
915	448	467	220	160	161	54.9
1041	508	533	235	300	197	81.4
1101	568	533	235	300	197	82.9
1204	628	576	235	300	197	90.4
1264	688	576	235	300	197	91.9
1324	748	576	235	300	197	93.4

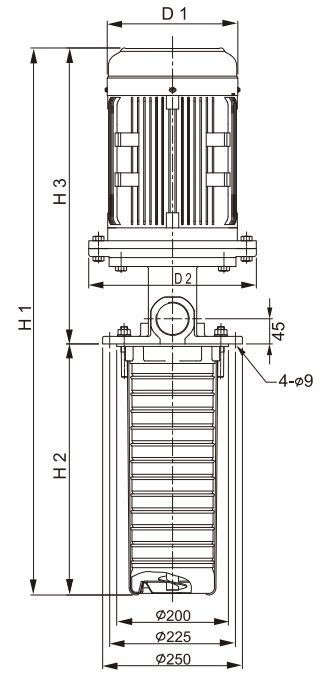
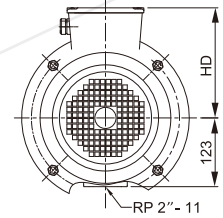

Technical Data

ECT PUMP

Performance Range

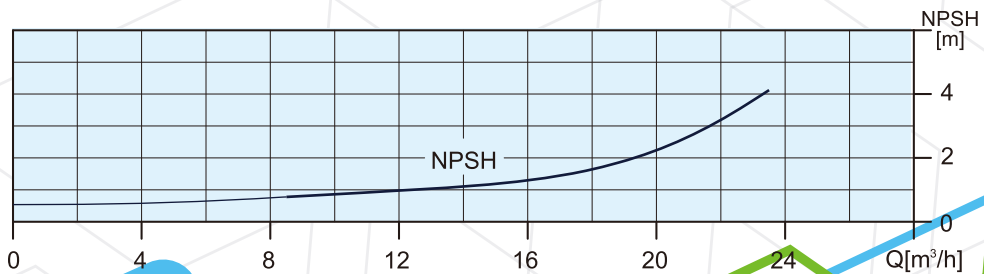
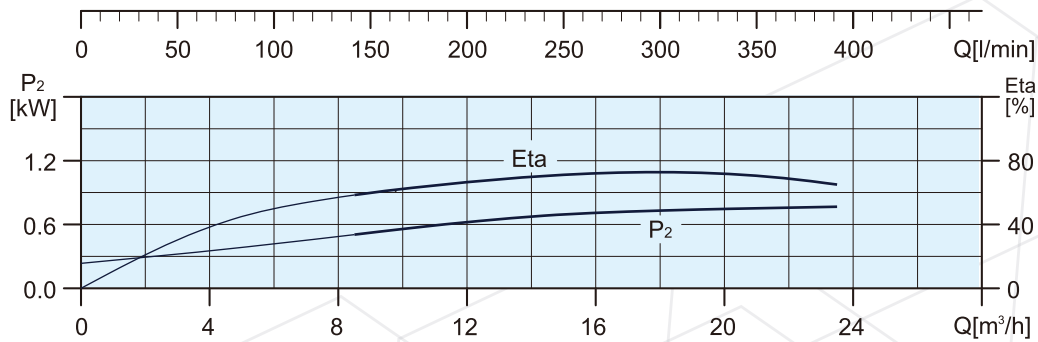
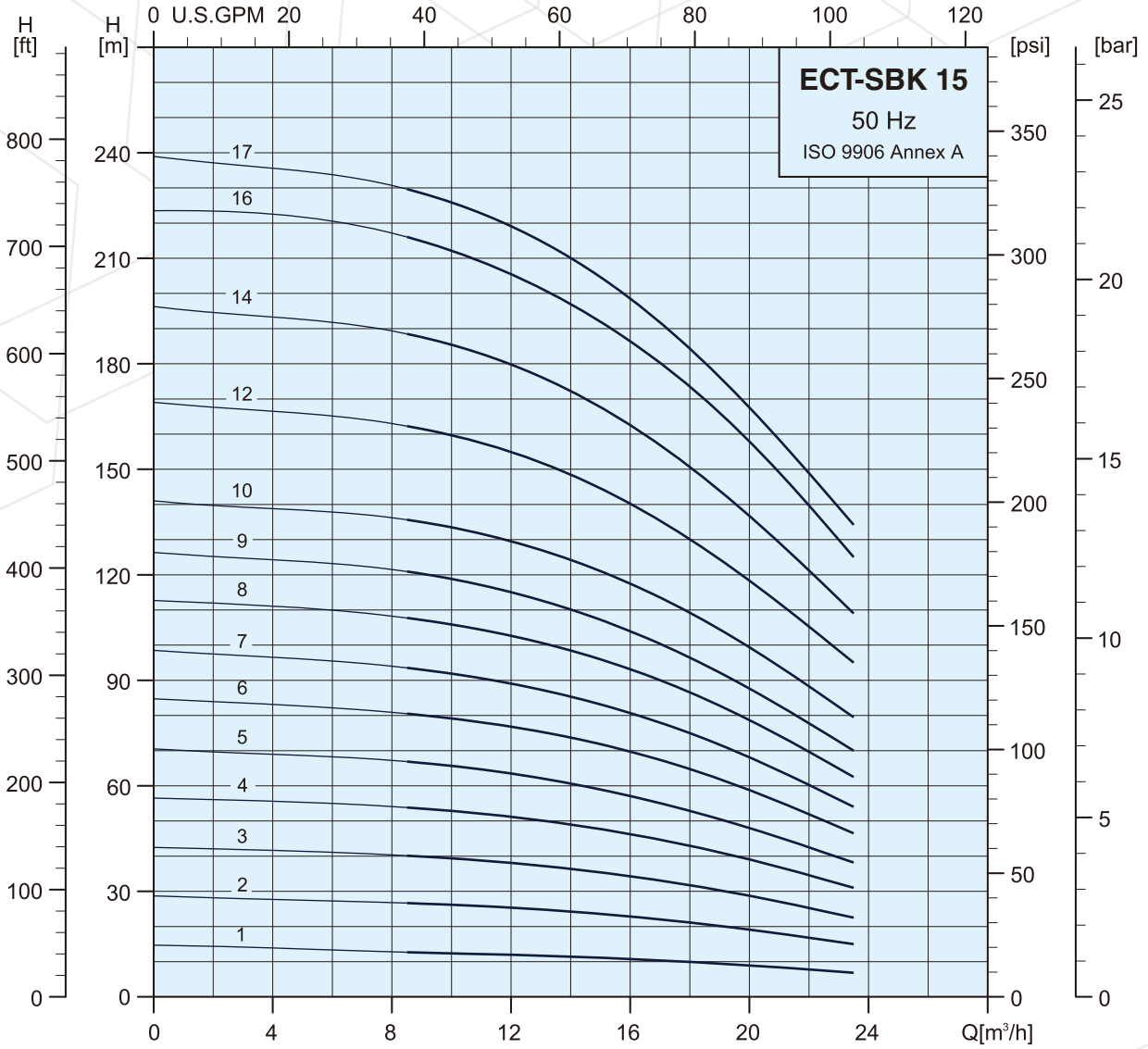

Specifications

Pump Type	Motor	
	P ₂	
	kW	HP
ECT-SBK 15-2/1	1.1	1.5
ECT-SBK 15-2/2	2.2	3.0
ECT-SBK 15-3/3	3.0	4.0
ECT-SBK 15-4/4	4.0	5.5
ECT-SBK 15-5/5	4.0	5.5
ECT-SBK 15-6/6	5.5	7.5
ECT-SBK 15-7/7	5.5	7.5
ECT-SBK 15-8/8	7.5	10.0
ECT-SBK 15-9/9	7.5	10.0
ECT-SBK 15-10/10	11.0	15.0
ECT-SBK 15-12/12	11.0	15.0
ECT-SBK 15-14/14	11.0	15.0
ECT-SBK 15-16/16	15.0	20.0
ECT-SBK 15-17/17	15.0	20.0

Dimensions and Weights

Dimensions (mm)						Net Weight (kg)
H1	H2	H3	D1	D2	HD	
607	178	429	177	140	141	29.2
613	178	435	177	140	141	35.6
680	223	457	197	160	147	38.9
735	268	467	220	160	161	47.3
780	313	467	220	160	161	51.2
891	358	533	235	300	197	77.2
936	403	533	235	300	197	78.2
1024	448	576	235	300	197	85.2
1069	493	576	235	300	197	86.2
1183	538	645	269	352	215	117.2
1273	628	645	269	352	215	119.2
1363	718	645	269	352	215	121.3
1498	808	690	269	352	215	133.8
1543	853	690	269	352	215	134.9

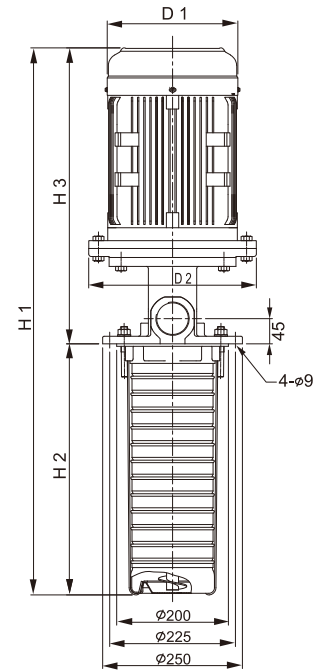
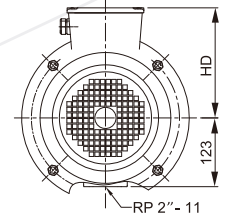

Performance Range

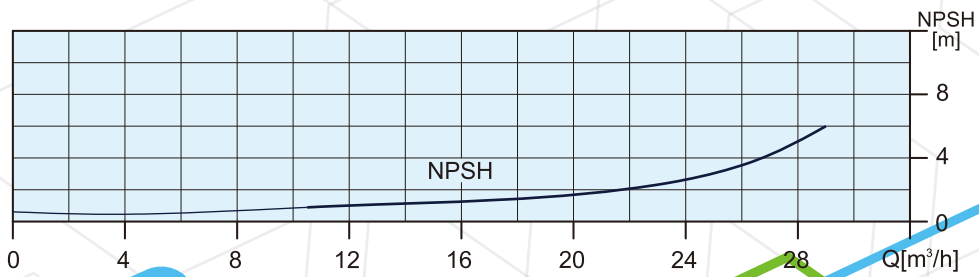
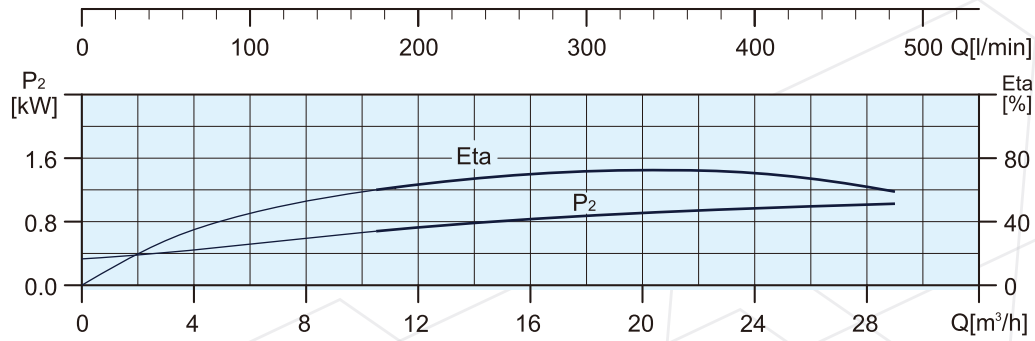
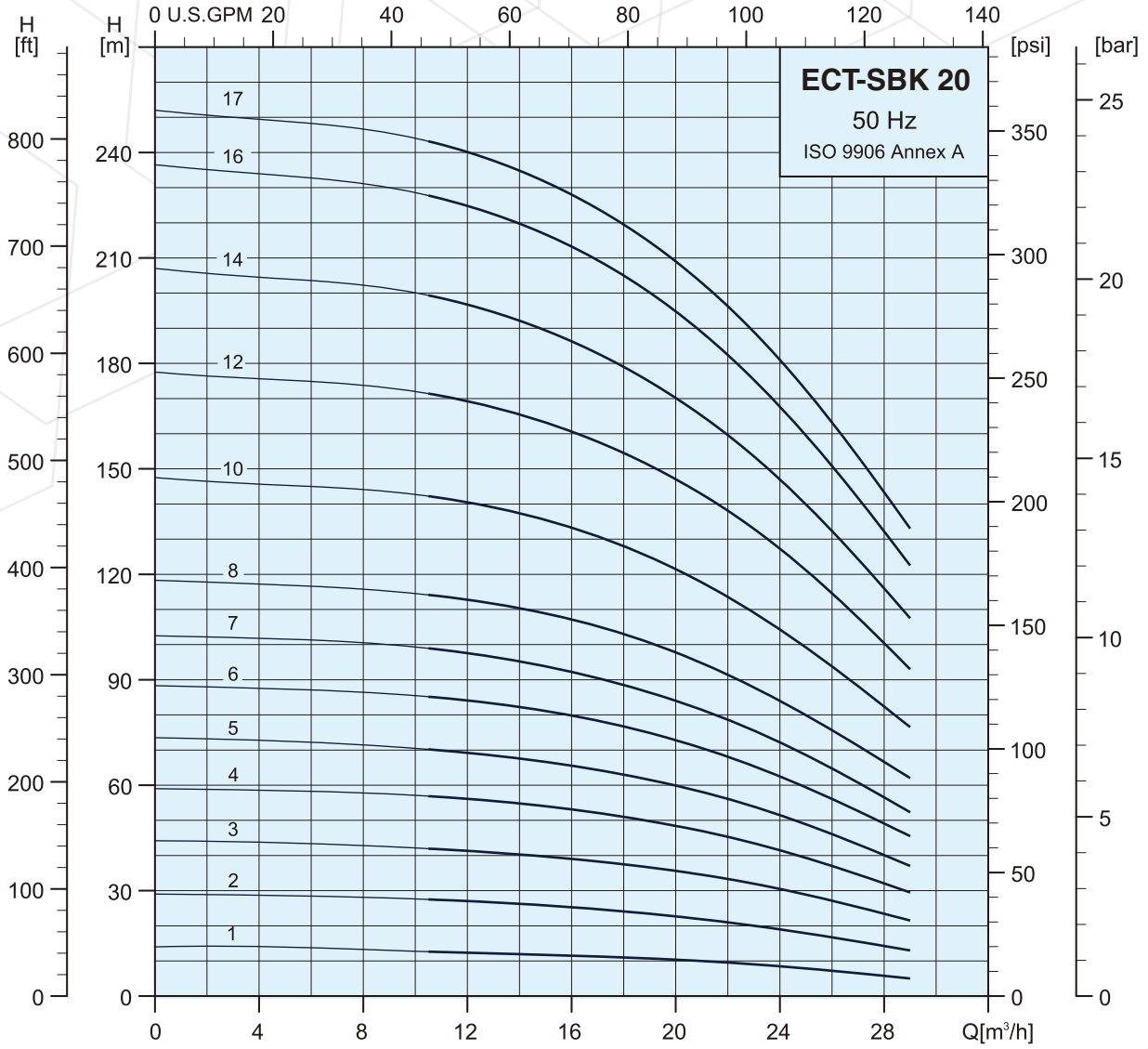

Specifications

Pump Type	Motor	
	P ₂	
	kW	HP
ECT-SBK 20-2/1	1.1	1.5
ECT-SBK 20-2/2	2.2	3.0
ECT-SBK 20-3/3	4.0	5.5
ECT-SBK 20-4/4	5.5	7.5
ECT-SBK 20-5/5	5.5	7.5
ECT-SBK 20-6/6	7.5	10.0
ECT-SBK 20-7/7	7.5	10.0
ECT-SBK 20-8/8	11.0	15.0
ECT-SBK 20-10/10	11.0	15.0
ECT-SBK 20-12/12	15.0	20.0
ECT-SBK 20-14/14	15.0	20.0
ECT-SBK 20-16/16	18.5	25.0
ECT-SBK 20-17/17	18.5	25.0

Dimensions and Weights

Dimensions (mm)						Net Weight (kg)
H1	H2	H3	D1	D2	HD	
607	178	429	177	140	141	29.2
613	178	435	177	140	141	35.6
690	223	467	220	160	161	49.3
801	268	533	235	300	197	75.2
846	313	533	235	300	197	76.2
934	358	576	235	300	197	83.2
979	403	576	235	300	197	84.2
1093	448	645	269	352	215	115.3
1183	538	645	269	352	215	117.2
1318	628	690	269	352	215	129.8
1408	718	690	269	352	215	131.8
1548	808	740	318	352	241	166.7
1593	853	740	318	352	241	167.7

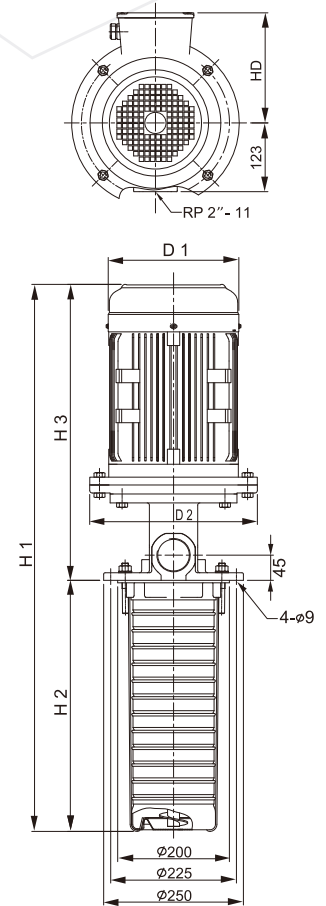

Technical Data

ECT PUMP

Performance Range

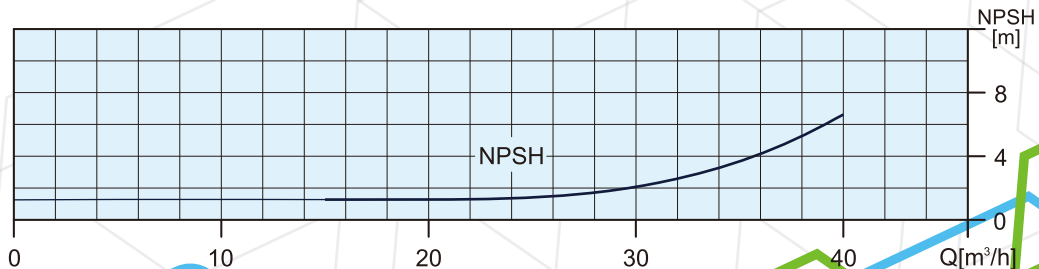
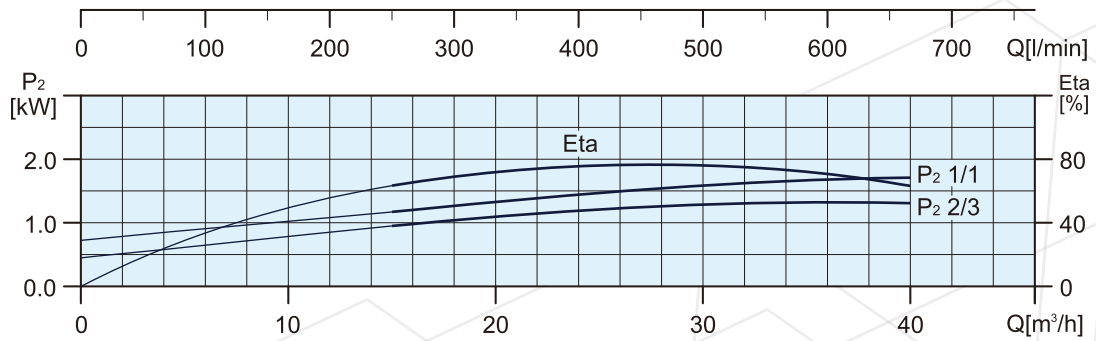
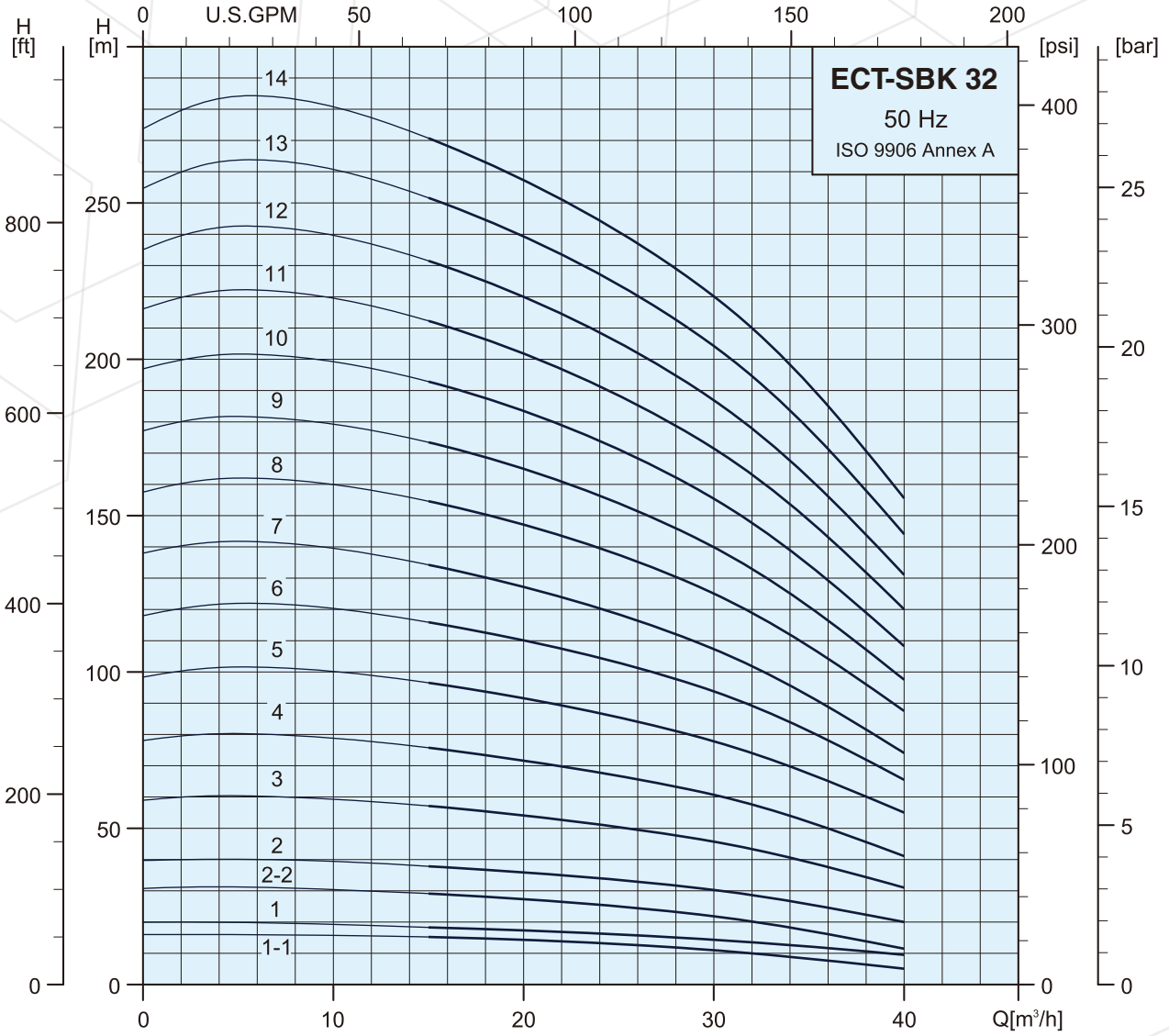

Specifications

Pump Type	Motor	
	P ₂	
	kW	HP
ECT-SBK 32-2/1-1	1.5	2.0
ECT-SBK 32-2/1	2.2	3.0
ECT-SBK 32-2/2-2	3.0	4.0
ECT-SBK 32-2/2	4.0	5.5
ECT-SBK 32-3/3	5.5	7.5
ECT-SBK 32-4/4	7.5	10.0
ECT-SBK 32-5/5	11.0	15.0
ECT-SBK 32-6/6	11.0	15.0
ECT-SBK 32-7/7	15.0	20.0
ECT-SBK 32-8/8	15.0	20.0
ECT-SBK 32-9/9	18.5	25.0
ECT-SBK 32-10/10	18.5	25.0
ECT-SBK 32-11/11	22.0	30.0
ECT-SBK 32-12/12	22.0	30.0
ECT-SBK 32-13/13	30.0	40.0
ECT-SBK 32-14/14	30.0	40.0

Dimensions and Weights

Dimensions (mm)								Net Weight (kg)
H1	H2	H3	H4	D1	D2	HD		
656	223	138	295	177	200(B5)	141	43.2	
656	223	138	295	177	200(B5)	141	45.5	
677	223	138	316	197	160(B14)	147	50.8	
687	223	138	326	220	160(B14)	161	57.6	
864	293	209	362	235	300(B5)	197	85.4	
977	363	209	405	235	300(B5)	197	93.4	
1087	433	209	445	269	350(B5)	215	125.2	
1157	503	209	445	269	350(B5)	215	127.4	
1272	573	209	490	269	350(B5)	215	140.1	
1342	643	209	490	269	350(B5)	215	142.1	
1462	713	209	540	318	350(B5)	241	177.3	
1532	783	209	540	318	350(B5)	241	179.4	
1602	853	209	540	318	350(B5)	241	194.9	
1672	923	209	540	318	350(B5)	241	197.0	
1862	993	209	660	390	400(B5)	295	219.5	
1932	1063	209	660	390	400(B5)	295	293.6	

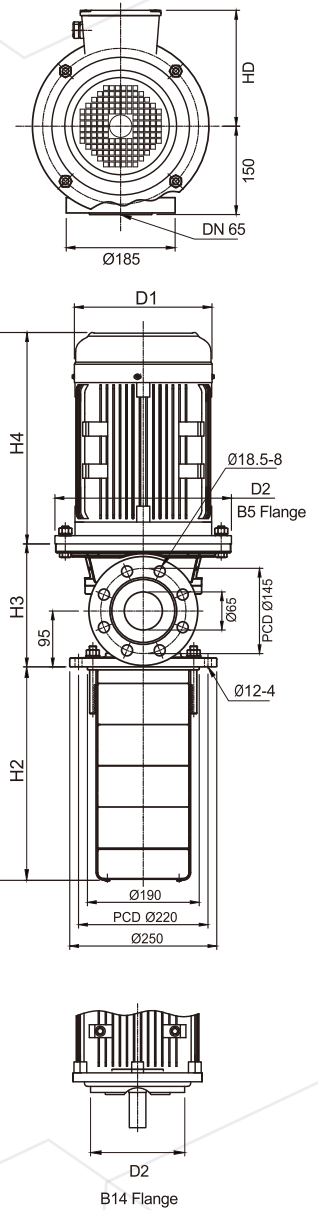

Performance Range

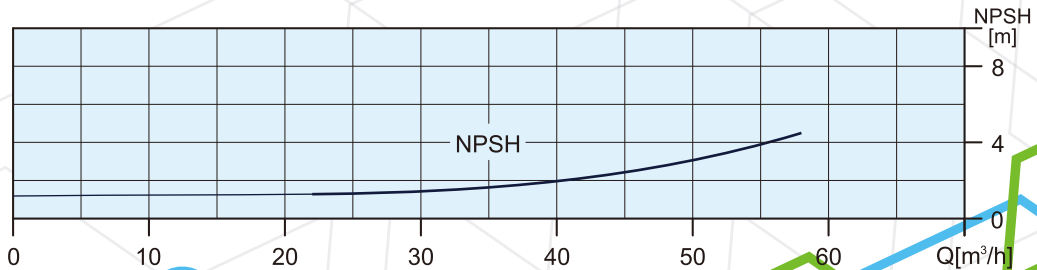
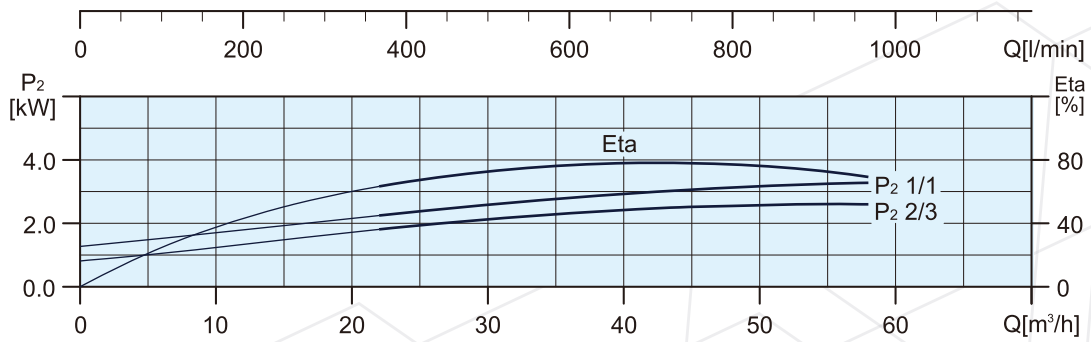
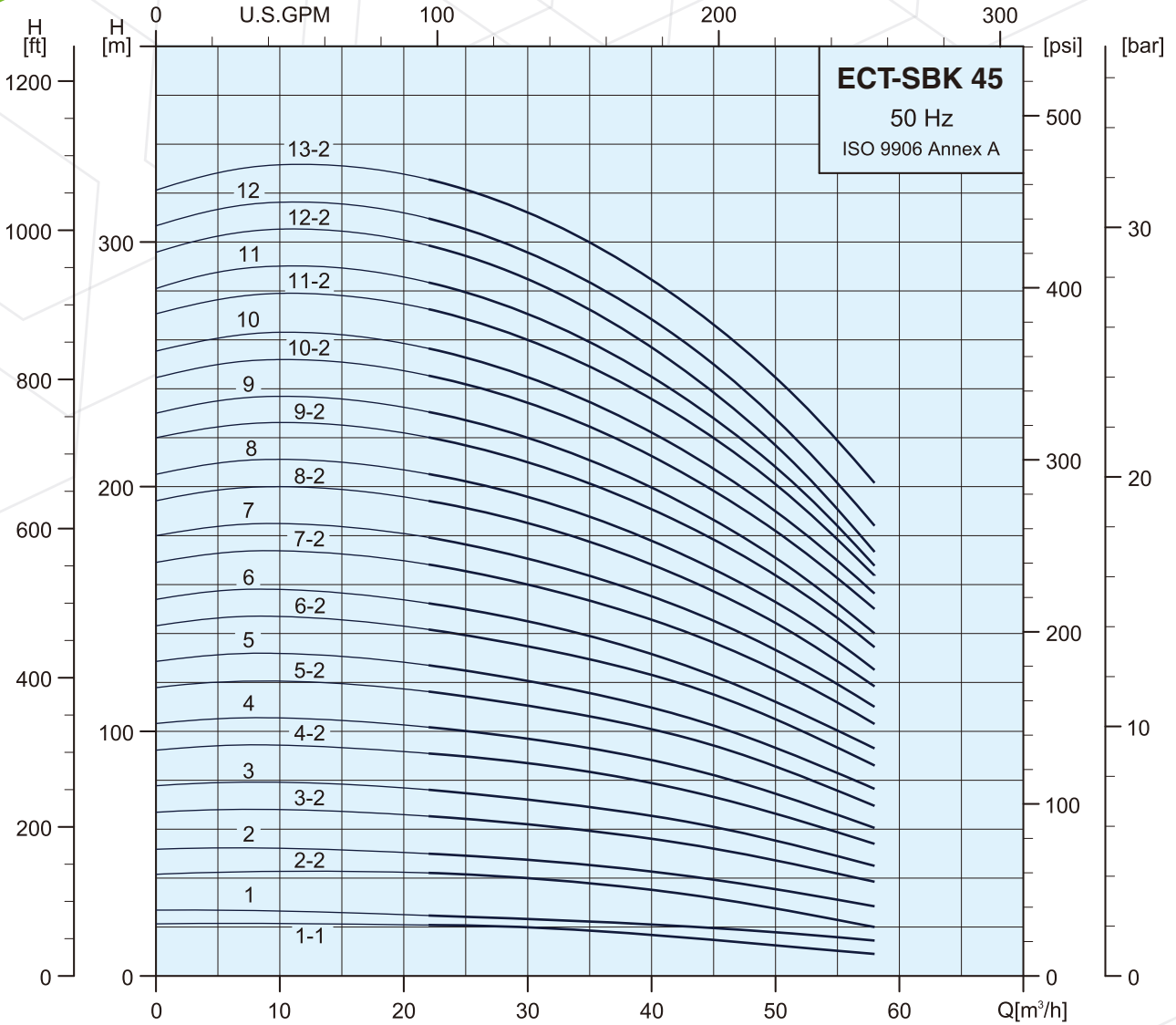

Specifications

Pump Type	Motor	
	P ₂	
	kW	HP
ECT-SBK 45-2/1-1	3.0	4.0
ECT-SBK 45-2/1	4.0	5.5
ECT-SBK 45-2/2-2	5.5	7.5
ECT-SBK 45-2/2	7.5	10.0
ECT-SBK 45-3/3-2	11.0	15.0
ECT-SBK 45-3/3	11.0	15.0
ECT-SBK 45-4/4-2	15.0	20.0
ECT-SBK 45-4/4	15.0	20.0
ECT-SBK 45-5/5-2	18.5	25.0
ECT-SBK 45-5/5	18.5	25.0
ECT-SBK 45-6/6-2	22.0	30.0
ECT-SBK 45-6/6	22.0	30.0
ECT-SBK 45-7/7-2	30.0	40.0
ECT-SBK 45-7/7	30.0	40.0
ECT-SBK 45-8/8-2	30.0	40.0
ECT-SBK 45-8/8	30.0	40.0
ECT-SBK 45-9/9-2	30.0	40.0
ECT-SBK 45-9/9	37.0	50.0
ECT-SBK 45-10/10-2	37.0	50.0
ECT-SBK 45-10/10	37.0	50.0
ECT-SBK 45-11/11-2	45.0	60.0
ECT-SBK 45-11/11	45.0	60.0
ECT-SBK 45-12/12-2	45.0	60.0
ECT-SBK 45-12/12	45.0	60.0
ECT-SBK 45-13/13-2	45.0	60.0

Dimensions and Weights

Dimensions (mm)								Net Weight (kg)
H1	H2	H3	H4	D1	D2	HD		
729	244	169	316	197	160(B14)	147	55.3	
739	244	169	326	220	160(B14)	161	62.2	
846	244	240	362	235	300(B5)	197	89.6	
889	244	240	405	235	300(B5)	197	95.5	
1009	324	240	445	269	350(B5)	215	127.8	
1009	324	240	445	269	350(B5)	215	127.8	
1134	404	240	490	269	350(B5)	215	141.0	
1134	404	240	490	269	350(B5)	215	141.0	
1264	484	240	540	318	350(B5)	241	176.7	
1264	484	240	540	318	350(B5)	241	176.7	
1344	564	240	540	318	350(B5)	241	192.7	
1344	564	240	540	318	350(B5)	241	192.7	
1544	644	240	660	390	400(B5)	295	290.9	
1544	644	240	660	390	400(B5)	295	290.9	
1624	724	240	660	390	400(B5)	295	293.5	
1624	724	240	660	390	400(B5)	295	293.5	
1704	804	240	660	390	400(B5)	295	296.3	
1704	804	240	660	390	400(B5)	295	314.3	
1784	884	240	660	390	400(B5)	295	316.9	
1784	884	240	660	390	400(B5)	295	316.9	
1913	964	259	690	446	450(B5)	325	404.6	
1913	964	259	690	446	450(B5)	325	404.6	
1993	1044	259	690	446	450(B5)	325	407.3	
1993	1044	259	690	446	450(B5)	325	407.3	
2073	1124	259	690	446	450(B5)	325	410.0	

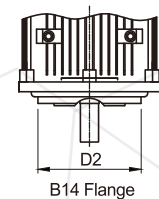
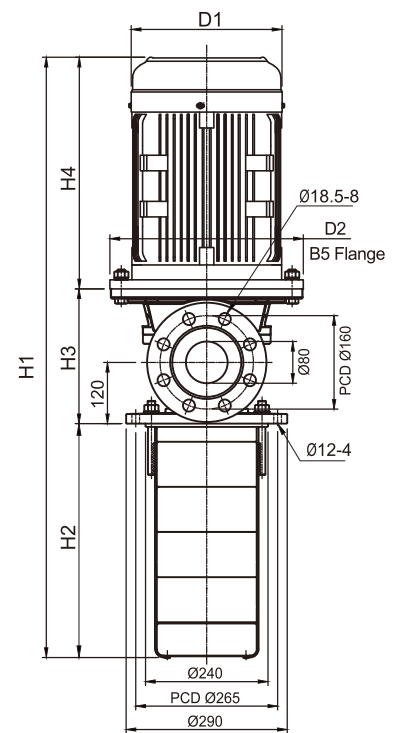
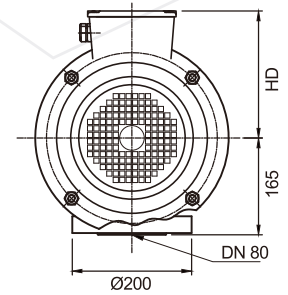

Performance Range

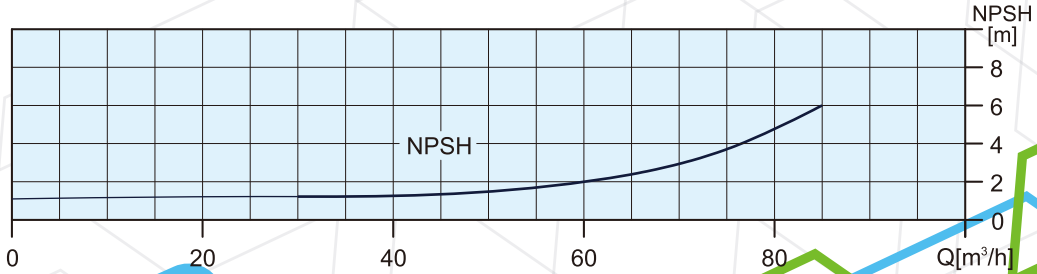
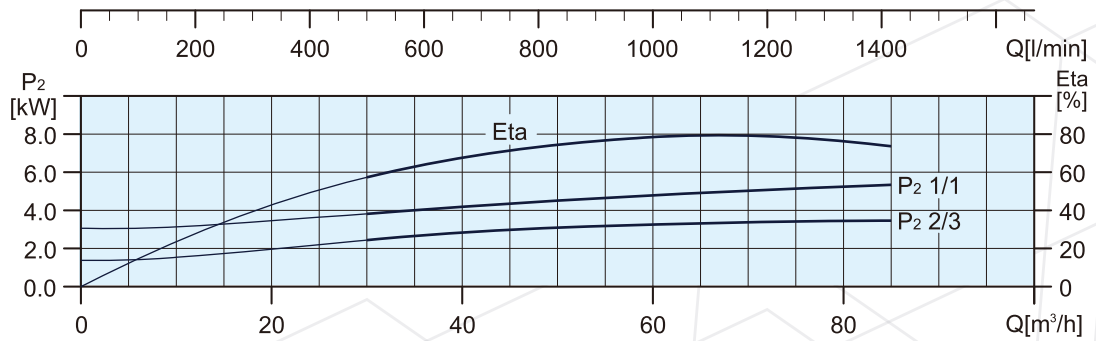
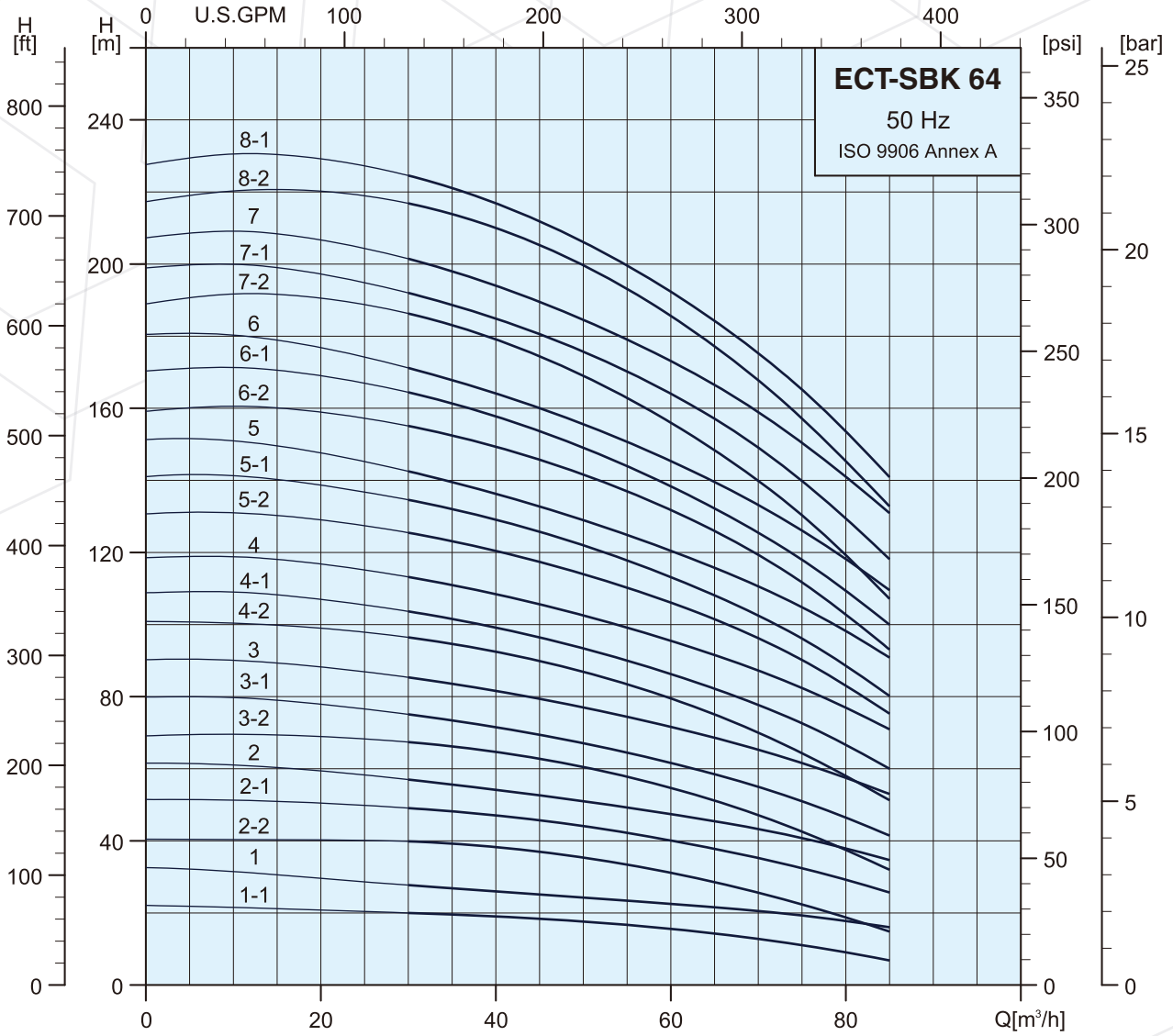

Specifications

Pump Type	Motor	
	P ₂	
	kW	HP
ECT-SBK 64-2/1-1	4.0	5.5
ECT-SBK 64-2/1	5.5	7.5
ECT-SBK 64-2/2-2	7.5	10.0
ECT-SBK 64-2/2-1	11.0	15.0
ECT-SBK 64-2/2	11.0	15.0
ECT-SBK 64-3/3-2	15.0	20.0
ECT-SBK 64-3/3-1	15.0	20.0
ECT-SBK 64-3/3	18.5	25.0
ECT-SBK 64-4/4-2	18.5	25.0
ECT-SBK 64-4/4-1	22.0	30.0
ECT-SBK 64-4/4	22.0	30.0
ECT-SBK 64-5/5-2	30.0	40.0
ECT-SBK 64-5/5-1	30.0	40.0
ECT-SBK 64-5/5	30.0	40.0
ECT-SBK 64-6/6-2	30.0	40.0
ECT-SBK 64-6/6-1	37.0	50.0
ECT-SBK 64-6/6	37.0	50.0
ECT-SBK 64-7/7-2	37.0	50.0
ECT-SBK 64-7/7-1	37.0	50.0
ECT-SBK 64-7/7	45.0	60.0
ECT-SBK 64-8/8-2	45.0	60.0
ECT-SBK 64-8/8-1	45.0	60.0

Dimensions and Weights

Dimensions (mm)								Net Weight (kg)
H1	H2	H3	H4	D1	D2	HD		
744	249	169	326	220	160(B14)	161	63.4	
851	249	240	362	235	300(B5)	197	89.6	
894	249	240	405	235	300(B5)	197	96.3	
934	249	240	445	269	350(B5)	215	125.9	
934	249	240	445	269	350(B5)	215	125.9	
1062	332	240	490	269	350(B5)	215	139.4	
1062	332	240	490	269	350(B5)	215	139.4	
1112	332	240	540	318	350(B5)	241	172.3	
1194	414	240	540	318	350(B5)	241	175.2	
1194	414	240	540	318	350(B5)	241	188.6	
1194	414	240	540	318	350(B5)	241	188.6	
1397	497	240	660	390	400(B5)	295	287.2	
1397	497	240	660	390	400(B5)	295	287.2	
1397	497	240	660	390	400(B5)	295	287.2	
1479	579	240	660	390	400(B5)	295	290.2	
1479	579	240	660	390	400(B5)	295	308.2	
1479	579	240	660	390	400(B5)	295	308.2	
1562	662	240	660	390	400(B5)	295	311.0	
1562	662	240	660	390	400(B5)	295	311.0	
1611	662	259	690	446	450(B5)	325	396.2	
1693	744	259	690	446	450(B5)	325	399.0	
1693	744	259	690	446	450(B5)	325	399.0	

