

ECT-D series 50HZ

Submersible Wastewater / Sump Pumps



ECT PUMP



APPLICATIONS

1. Basement water removal
2. Waste water drainage
3. Water transfer
4. Sump / effluent handling
5. Dewatering
6. Fish pond & fountain circulation
7. Factory waste water handling

Motor Data

1. Motor Type : 2 pole, dry type
2. Frequency : 50Hz
3. Nominal Speed : 2850 rpm
4. Insulation Class : F class (155°C)
5. Enclosure Protection Class : IP68
6. Protection Device :
Thermal Protector (Single phase)
Overload Protector (Three phase)

Pump Data

1. Impeller : Semi Open Impeller
2. Shaft Seal : Double Mechanical Seal+ oil seal
3. Bearing : Double-shielded Ball Bearing

Operating Conditions

1. Fluid Temperature : 0 to 50°C(0-122°F)

MATERIAL CONSTRUCTION

No.	Part	Materials
1	Cable	H07RN-F
2	Handle	Nylon6+30GF(0.5~1HP) AISI 304+NBR(2~5HP) SS41(7.5HP)
3	Motor Cover	FC200
4	Bearing Cap	FC200
5	Motor Frame	AISI 304
6	Bearing Bracket	FC200
7	M.Seal Bracket	FC200
8	Shaft	SUS 410
9	Mechanical Seal	CA / CE , SIC / SIC
10	Oil Seal	NBR 70
11	Impeller	FC200
12	Pump Casing	FC200
13	Flange	FC200
14	Elbow	FC200
15	Foot Casting	FC200
16	Strainer	AISI 304

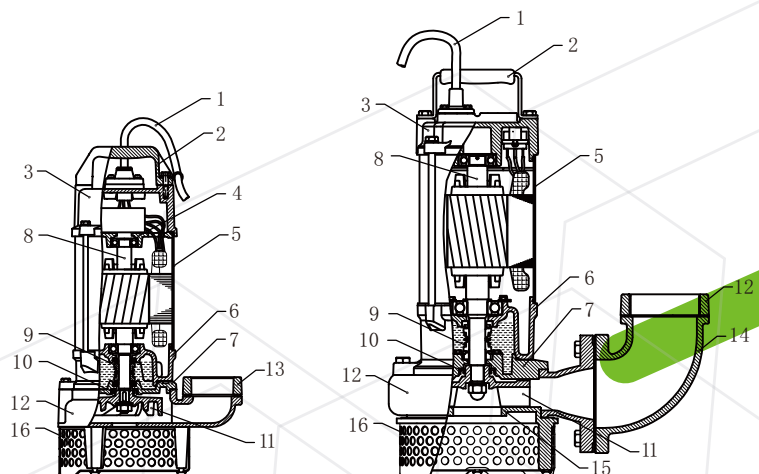



ECT PUMP

ECT-D series Technical Data

PERFORMANCE CURVE

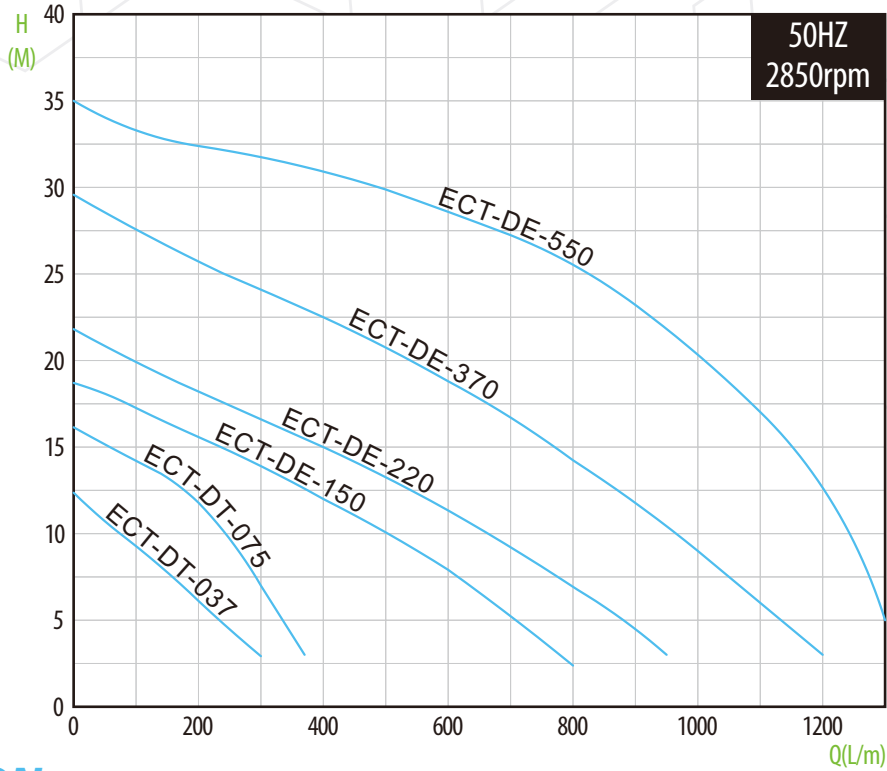

SPECIFICATION

Model	Power HP(kW)	Discharge Inch(mm)	Nominal Current(A)		Capacitort (UF / V)		Std. Head M	Std. Flow LPM	Max. Head M	Max. Flow LPM	Weight KG
			220 - 240V		220-240V						
Single Phase & Auto Float Switch											
ECT-DT(A)-1037-50	0.5 (0.37)	2" (50)	3.6 - 3.4		12 / 450		7.5	170	12	300	16 / 16.5
ECT-DT(A)-1075-50	1 (0.75)	2" (50)	5.2 - 4.8		20 / 450		11	220	16.5	370	18 / 18.5
ECT-DE(A)-1150-50/80	2 (1.5)	2"/3" (50/80)	10.0 - 9.2		40 / 450		10.3	525	18.9	800	42.5 / 43

ECT-VT : Thread
ECT-VE : Elbow
A : Auto Float Switch

Model	Power HP(kW)	Discharge Inch(mm)	Nominal Current [A]		Std. Head M	Std. Flow LPM	Max. Head M	Max. Flow LPM	Weight KG		
			220 - 240V							380 - 415V	
Three Phase & With Elbow											
ECT-DT-3037-50	0.5 (0.37)	2"(50)	2.5 - 2.3		1.2 - 1.1		7.5	170	12	300	15
ECT-DT-3075-50	1 (0.75)	2"(50)	3.5 - 3.2		2.0 - 1.8		11	220	16.5	370	17
ECT-DE-3150-50/80	2 (1.5)	2"/3"(50/80)	6.5 - 6.0		3.7 - 3.5		10.3	525	18.9	800	36
ECT-DE-3220-50/80	3 (2.2)	2"/3"(50/80)	8.7 - 8.0		5.0 - 4.6		13.5	500	22	965	38.5
ECT-DE-3370-80/100	5 (3.7)	3"/4"(80/100)	14.2 - 13.0		8.2 - 7.6		20	485	29.6	1200	45
ECT-DE-3550-80/100	7.5 (5.5)	3"/4"(80/100)	21.0 - 19.3		12.0 - 11.0		26	780	35	1300	62

ECT-VT : Thread
ECT-VE : Elbow
A : Auto Float Switch

ECT-D series Technical Data



ECT PUMP

DIMENSIONS

C.W.L. : Continuous running water level

L.W.L. : Lowest running water level

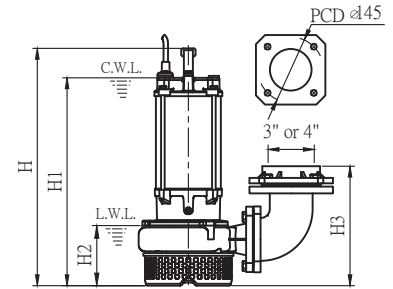
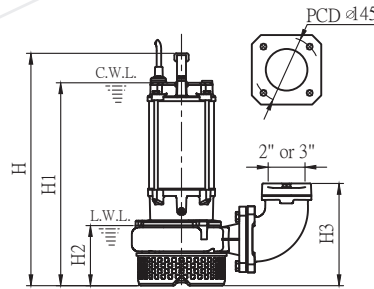
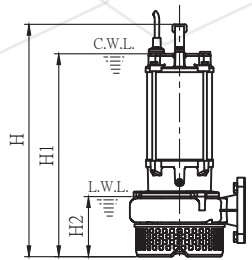
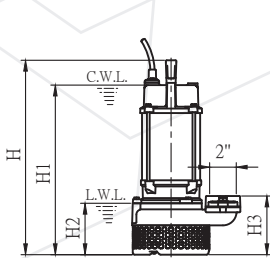
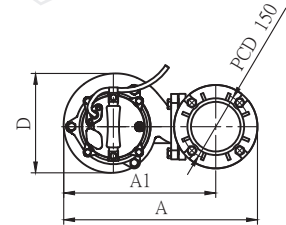
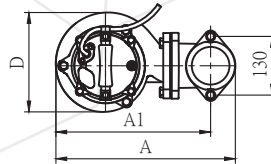
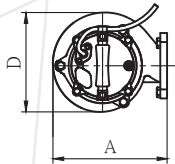
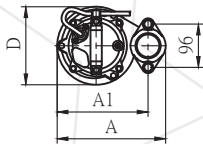

ECT-DT
For 0.5HP & 1HP

ECT-D
For 2HP & 3HP
For 5HP-3 3/4"

ECT-DE W/Elbow
For 2HP & 3HP

ECT-DE W/Elbow
For 5HP-3 3/4"

Model	A	A1	D	H	H1	H2	H3	Solid Passage (mm)	Cable	
									M	H07 RN-F
Single Phase & Auto Float Switch										
ECT-DT(A)-1037-50	240	201	173	411	356	114	130	10	10	3G1.0mm ²
ECT-DT(A)-1075-50	240	201	173	431	376	114	130	10	10	3G1.0mm ²
ECT-D(A)-1150-50/80	398	343	220	506	441	133	227	10	10	3G1.5mm ²
Three Phase										
ECT-DT-3037-50	240	201	173	411	356	114	130	10	10	4G1.0mm ²
ECT-DT-3075-50	240	201	173	431	376	114	130	10	10	4G1.0mm ²
ECT-D-3150-50/80	398	-	220	506	441	133	-	10	10	4G1.5mm ²
ECT-D-3220-50/80	398	-	220	506	441	133	-	10	10	4G1.5mm ²
ECT-D-3370-80/100	430	-	220	526	461	133	-	10	10	4G2.5mm ²
ECT-D-3550-80/100	474	-	230	658	553	132	-	10	10	4G2.5mm ²
With Elbow										
ECT-DE-1150-50/80	398	343	220	506	441	133	227	10	10	3G1.5mm ²
ECT-DE-3150-50/80	398	343	220	506	441	133	227	10	10	4G1.5mm ²
ECT-DE-3220-50/80	398	343	220	506	441	133	227	10	10	4G1.5mm ²
ECT-DE-3370-80/100	430	337	220	526	461	133	265	10	10	4G2.5mm ²
ECT-DE-3550-80/100	474	380	230	658	553	132	265	10	10	4G2.5mm ²



ECT PUMP

TS-50



Pump Model	DN (mm)	Dimensions H1 (mm)
ECT-DT Series For 0.5 & 1 HP	50	31

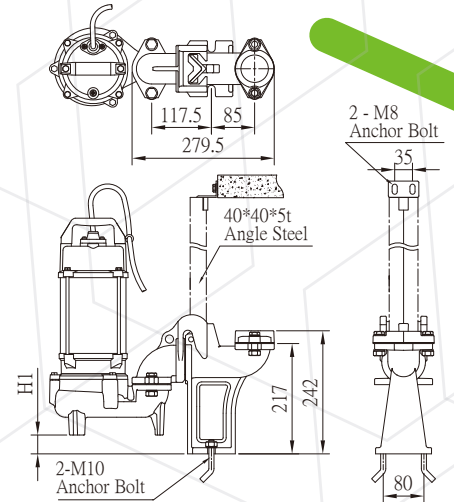

TM-50/80



Pump Model	DN (mm)	Dimensions H1 (mm)
ECT-DE Series For 2 & 3 HP	50 & 80	77.5

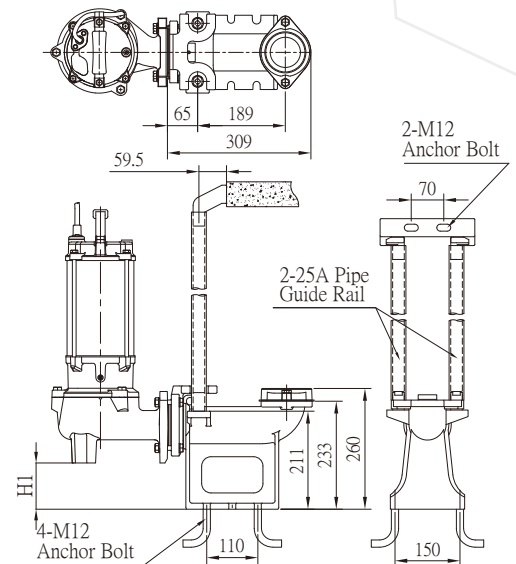

TL-80/100



Pump Model	DN (mm)	Dimensions H1 (mm)
ECT-DE Series For 5 & 7.5 HP	80 & 100	104.5

