

ECT-XD series 60Hz Submersible Drainage Pumps



ECT PUMP



Pump Data

1. Impeller : Vortex Impeller
2. Shaft Seal / Mechanical : Double Seal
3. Bearing : Double-shielded Ball Bearing

Operating Conditions

1. Fluid Temperature : 0 to 50°C(122°F)

Motor Data

1. Motor Type : 2 pole, dry type
2. Frequency : 60Hz
3. Nominal Speed : 3450 rpm
4. Insulation Class : F class (155°C)
5. Enclosure Protection Class : IP68
6. Protection Device :
Thermal Protector (Single phase)

APPLICATIONS

1. Basement water removal
2. Waste water drainage
3. Water transfer
4. Sump / effluent handling
5. Dewatering
6. Fish pond & fountain circulation
7. Factory waste water handling

MATERIAL CONSTRUCTION

No.	Part	Materials
1	Cable	STOW_UL
2	Handle	AISI 304+Nylon
3	Pump Cover	AISI 304
4	Motor Cover	AISI 304
5	Motor Casing	AISI 304
6	Fixing Ring	Nylon+30GF
7	Pump Body	AISI 304
8	Mechanical seal	Sic / Sic / NBR
9	Impeller	AISI 304
10	Key	AISI 304
11	O-ring	NBR
12	Oil Seal	NBR
13	Shaft	AISI 304
14	V-type Axial Oil Seal	NBR
15	Suction Flange	AISI 304 Thermoplastic Polyurethane TPU
16	Strainer	AISI 304
17	Pump Casing	AISI 304

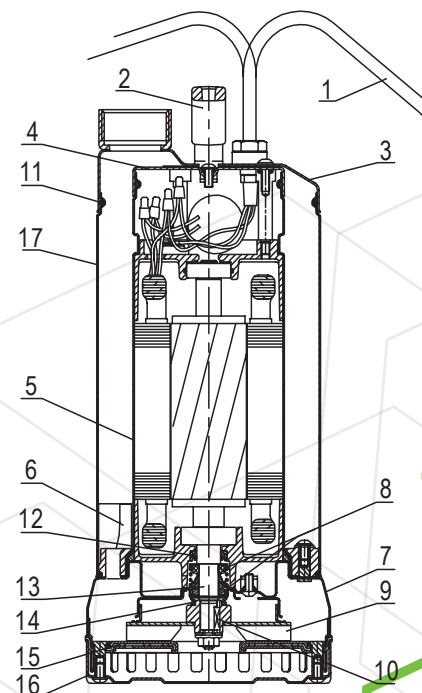



ECT-XD series

Submersible Drainage Pumps

ECT PUMP

PERFORMANCE CURVE

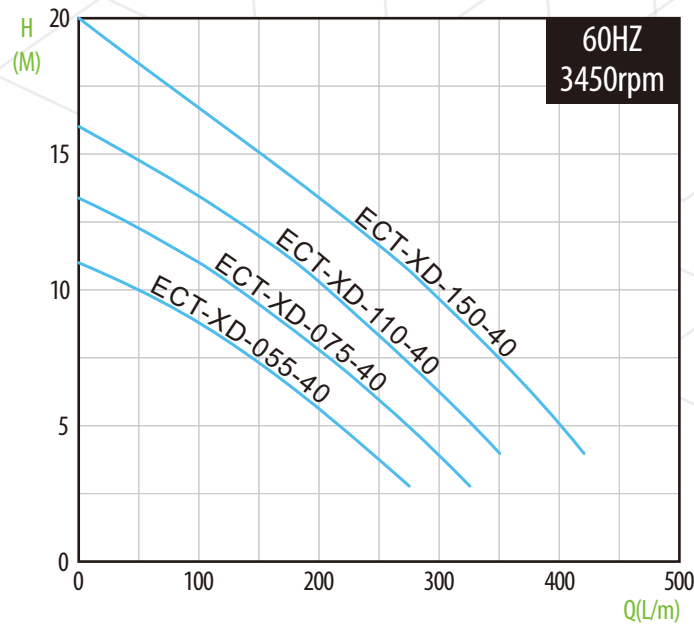

SPECIFICATION

A : Auto Float Switch

Model	Power HP(kw)	Discharge Inch(mm)	Nominal Current [A]		Capacitort		Std. Head M	Std. Flow LPM	Max. Head M	Max. Flow LPM	Weight KG
			110 - 127V	220 - 230V	110 - 127V UF / V	220 - 230V UF / V					
Single Phase & Auto Float Switch											
ECT-XD(A)-1055-40	0.75 (0.55)	1½" (40)	8.8 - 8.0	4.7 - 4.5	20 / 350	20 / 450	8.7	100	11	275	11 / 11.5
ECT-XD(A)-1075-40	1 (0.75)	1½" (40)	11.0 - 10.3	5.7 - 5.5	35 / 350	22 / 450	11	100	13.4	325	14 / 14.5
ECT-XD(A)-1110-40	1.5 (1.1)	1½" (40)	-	8.0 - 7.7	-	30 / 450	12	150	16	350	16 / 16.5

Model	Power HP(kw)	Discharge Inch(mm)	Nominal Current [A]			Std. Head M	Std. Flow LPM	Max. Head M	Max. Flow LPM	Weight KG
			220 - 230V	380 - 440V	460 - 480V					
Three Phase										
ECT-XD-3055-40	0.75 (0.55)	1½" (40)	2.4 - 2.3	1.4 - 1.3	1.2 - 1.0	8.7	100	11	275	11
ECT-XD-3075-40	1 (0.75)	1½" (40)	3.6 - 3.5	2.1 - 2.0	1.8 - 1.6	11	100	13.4	325	12
ECT-XD-3110-40	1.5 (1.1)	1½" (40)	4.1 - 4.0	2.4 - 2.3	2.3 - 2.1	12	150	16	350	14
ECT-XD-3150-40	2 (1.5)	1½" (40)	5.7 - 5.5	3.3 - 3.1	3.0 - 2.7	15	150	20	420	16

DIMENSIONS

Model	Discharge(mm)					Solid Passage (mm)	Cable	
	H	H1	H2	L	L1		UL	M
ECT-XD(A)-1055-40	357	437	341	459	370	8	16AWGx3C	10
ECT-XD-3055-40	357	-	341	-	-	8	16AWGx4C	10
ECT-XD(A)-1075-40	407	497	391	514	425	8	16AWGx3C	10
ECT-XD-3075-40	357	-	341	-	-	8	16AWGx4C	10
ECT-XD(A)-1110-40	407	497	391	514	425	8	14AWGx3C	10
ECT-XD-3110-40	407	-	391	-	-	8	14AWGx4C	10
ECT-XD-3150-40	407	-	391	-	-	8	14AWGx4C	10

